



THERMOTECHNIKA CROWN COOL



DESIGN
BOOK



Our vision

„Our company THERMOTECHNIKA BOHEMIA, as a member of the Central European group THERMOTECHNIKA CROWN COOL, enables mainly breweries and beverage companies in the Czech Republic to satisfy their customers' need for cooling refreshment, always economically, productively and from specially designed tapping, cooling or freezing equipment.

For customers, who appreciate the largest service network of tapping and refrigeration technology in Central and Eastern Europe, we offer:

- convenient and easy reporting of a malfunction to our central dispatching*
- quick and efficient removal of the fault with online tracking information from the service technician*
- comprehensive and modern installation and service procedures implemented by a team of reliable and helpful experts*
- assistance in finding and implementing new trends*
- long-term and mutually beneficial partnership.*

To satisfy the requirements of our customers, we promote an active business approach, systematic marketing, efficient purchasing and logistics and maximum use of information technology.

The basic determining factor in the functioning of our company is fairness, both inside and outside. This is what we follow throughout the existence of our company.“



JUDr. Dezider Imre
Managing director



Mgr. Silvia Štarhová
Managing director

About us

The company THERMOTECNIKA BOHEMIA has been operating in the Czech market as a **supplier of dispense equipment** since 1992. The current shape of the company is the result of long-lasting development and growth. In 1995 the company started to supply also **gastro equipment** and in 2004 it has become a supplier of high quality Pascucci coffee and its accessories.



In June 2007 THERMOTECNIKA BOHEMIA became a member of an international group **European Economic Interest Group THERMOTECNIKA CROWN COOL**

consolidating seven companies of six European states: the Czech Republic, Croatia, Hungary, Slovakia, Serbia and Romania.

Companies decided to perform under the common name and logo in order to support one another, cooperate and commonly offer products and services for continuous quality improvement.

More information are available on <http://www.tc-eu.com/>.

Dispense equipment

The main activity of the company is the **service, production and sale of dispense and cooling technology**.

The important company suppliers are the companies Bemeta Design s.r.o., Dunet, John Guest, Tubing Food and others.

THERMOTECNIKA BOHEMIA s.r.o. is representative of the Dutch company Gamko (producer of cooling technology) for the entire Czech Republic. Dittl Metal coolers are made under license in Dvory nad Žitavou, in Slovakia. We are also the exclusive supplier of Micro Matic in the Czech Republic.

Beer tanks

Our company is the exclusive supplier of **beer tanks of the Dutch company Fib Beer Systems** in the Czech Republic.

We offer **comprehensive solutions for tank technology, from the creation of the design to the installation of the entire tank technology and maintenance by our experienced technicians throughout the Czech Republic**. We also keep a stock of beer bags for our customers.

In addition to beer tanks, we also offer beer lorries or tanks designed for the transport of beer, tanks designed for various events (such as festivals), beer trailers and mobile bars.

Cooling and freezing chambers

To achieve the completeness of our range, we also offer customers unique **cooling and freezing chambers**, made according to the customer's wishes.

Service

In addition to the sale of quality products, we operate the largest and densest service network in the Czech Republic. Our qualified technicians perform **assembly, montage, disassembly, maintenance, sanitation and repair of dispense technology, cooling and freezing equipments, chambers, illuminated and non-illuminated advertisements**. We also provide **delivery, inspections, and storage of cooling and dispense equipment, support promotional events end**. The activities provided also include **certification of sanitation technicians, supply and installation of gastronomic equipment and tank technology**.

Where can you find us?



CZECH REPUBLIC
THERMOTECHNIKA BOHEMIA S.R.O.
 Komenského 951
 664 53 Újezd u Brna (Czech republic)
 Tel.: (+420) 544 229 478
 E-mail: obchod@tcbohemia.com
 Web: www.tcbohemia.com



CROATIA
CROWN COOL D.O.O.
 Kralja Petra Svacica 130,
 31 300 Beli Manastir (Croatia)
 Tel.: (+385) 31 700 611
 E-mail: tc@tccroatia.com
 Web: www.tccroatia.com



ROMANIA
CROWN COOL S.R.L.
 530240 Miercurea-Ciuc
 str. Toplita, nr. 155
 Jud. Harghita (Romania)
 Tel.: (+40) 266 317 827
 Fax: (+40) 266 315 068
 E-mail: office@tcromania.com
 Web: www.tcromania.com



SLOVAKIA
THERMOTECHNIKA CROWN COOL S.R.O.
DITL METAL S.R.O.
 Dvory nad Žitavou 2620
 941 31 (Slovakia)
 Tel.: (+421) (0) 911 277 482
 E-mail: info@tcslovakia.com
 Web: www.tcslovakia.com



HUNGARY
THERMOTECHNIKA-CROWN COOL KFT.
 H-1103 Budapest, Káér u. 3/F (Hungary)
 H-1475 Budapest, Pf.: 139. (Hungary)
 Tel.: (+36) 1 260 7082, (+36) 1 260 7126
 Fax: (+36) 1 433 3851
 E-mail: thermotechnika@tchungary.com
 Web: www.tchungary.com



SERBIA
THERMOTECHNIKA CROWN COOL D.O.O.
 24000 Subotica
 Bose Milčević 4. (Serbia)
 Tel.: (+381) 63 1030 353
 Tel.: (+381) 63 1030 073
 E-mail: info@tcserbia.com
 Web: www.tcserbia.com

Contents

Beer equipment and drink coolers

- Dispense towers
- Dispense equipment
- Wine tap
- Undercounter beer coolers
- Countertop beer coolers
- Flexidraft
- KEG barrel coolers
- Dolium Kegs

Beverage accessories

- KEG Couplers
- Pressure reducers
- Compressors
- Glass washers
- Drip trays / Pythons & tubing
- Cooler accessories
- Sanitation

Spears

Cooling and freezing equipment

- Coolers
- Wine coolers

Stainless steel bar counters

Cooling and freezing chambers

Beer tanks

Beer equipment and drink coolers

- Dispense towers
- Dispense equipment
- Wine tap
- Undercounter beer coolers
- Countertop beer coolers
- Flexidraft
- KEG barrel coolers
- Dolium Kegs



**THERMOTECHNIKA
CROWN COOL**



Dispense towers with a unique design

We offer complete solutions from design, development, prototyping to production of your unique dispense tower.

- sketch
- 3D model
- 1:1 model
- prototype
- realization





stainless
steel

gloss

ground

titanium

swept
copper

Dispense towers



Beer tower TC Brauhaus

- Selected product version: TC Brauhaus ST4 copper
- Material: stainless steel
- Surface finish: polished/brushed stainless steel, titanium
- Special surface finish: galvanic copper plating or any color according to the customer's wishes
- Completely cooled up to the taps
- Number of taps: 4 – X
- Spacing between dispense taps: 150 mm
- Possibility of design without medallion holders
- Mounting holes under dispense taps
- Including tower cooling for the beer line 6,7 x 9,5 mm / 9,5 x 12,7 mm

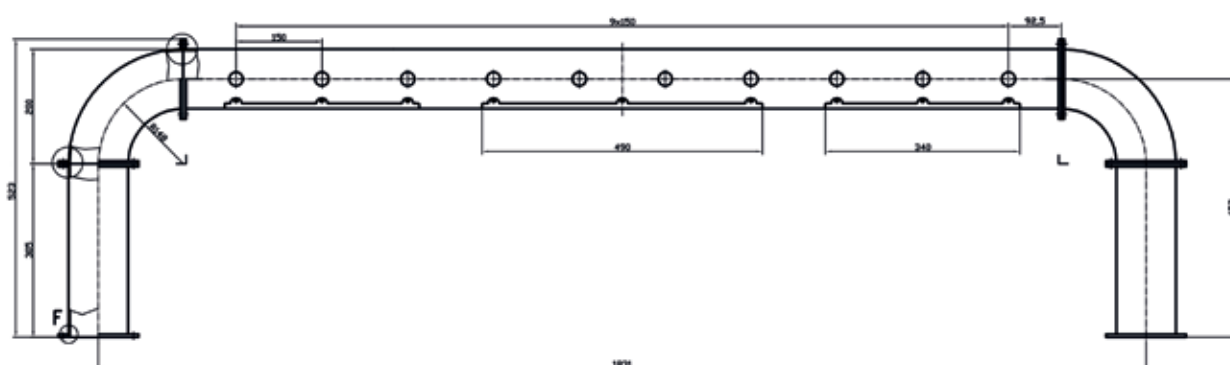

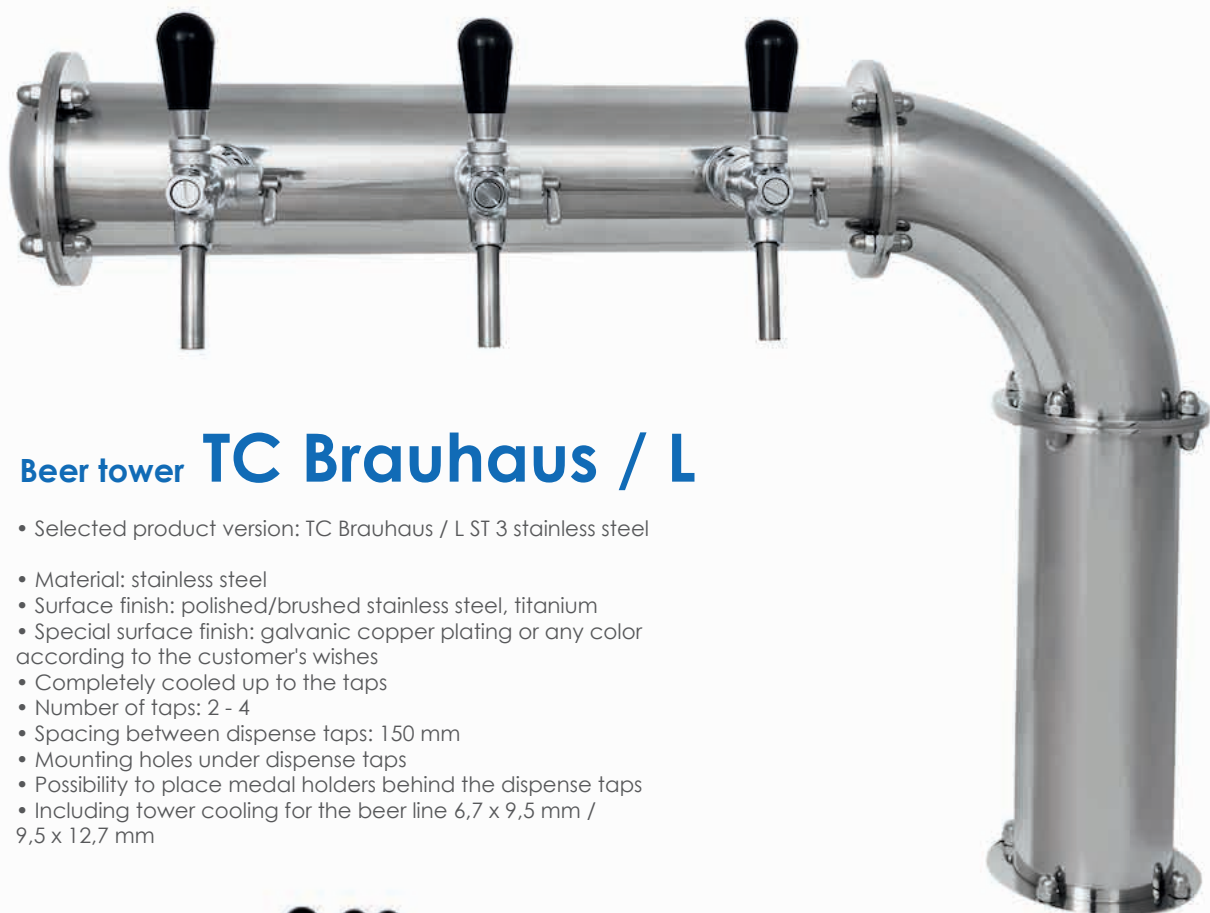

Beer tower TC Brauhaus / L

• Selected product version: TC Brauhaus / L ST 3 stainless steel

- Material: stainless steel
- Surface finish: polished/brushed stainless steel, titanium
- Special surface finish: galvanic copper plating or any color according to the customer's wishes
- Completely cooled up to the taps
- Number of taps: 2 - 4
- Spacing between dispense taps: 150 mm
- Mounting holes under dispense taps
- Possibility to place medal holders behind the dispense taps
- Including tower cooling for the beer line 6,7 x 9,5 mm / 9,5 x 12,7 mm

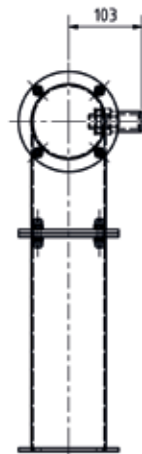
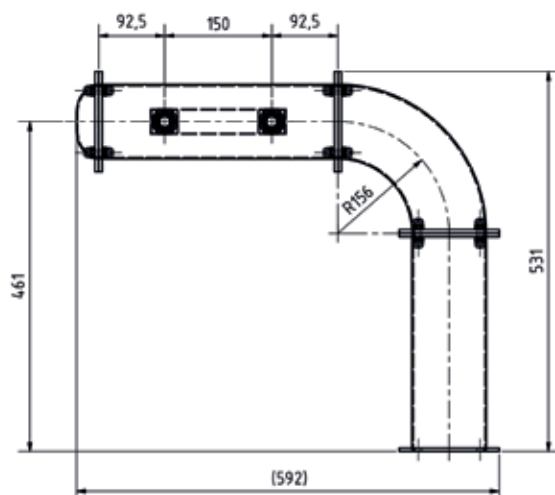

stainless
steel

gloss

ground

titanium

swept
copper

Dispense towers

Beer equipment
and drink coolers



stainless
steel

gloss

ground

titanium

swept
copper

Dispense towers



Beer tower TC Halm

- Selected product version: TC Halm ST5 copper
- Material: stainless steel
- Surface finish: polished/brushed stainless steel, titanium
- Special surface finish: galvanic copper plating or any color according to the customer's wishes
- Completely cooled up to the taps
- Number of taps: 2 - 7
- Spacing between dispense taps: 150 mm
- Mounting holes under dispense taps
- Possibility to place medal holders behind the dispense taps or completely without medallion holders
- Beer line 6,7 x 9,5 mm / 9,5 x 12,7 mm (only for 2 to 6 beer taps), with cooling coils

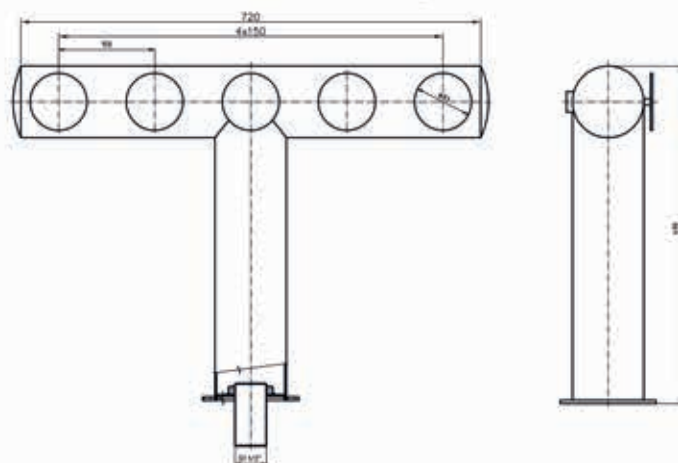

- Also available in Halm T 2 version

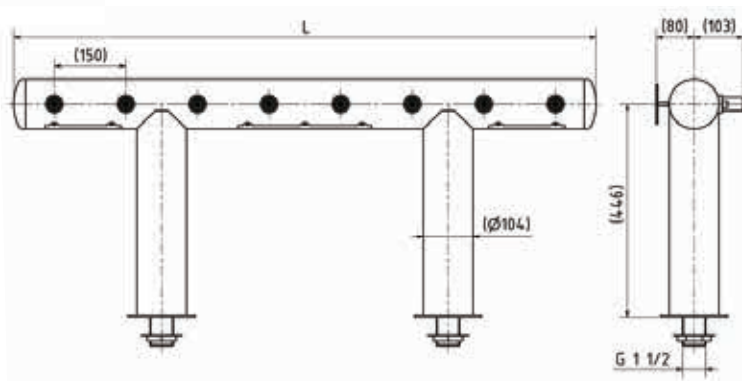

Beer equipment
and drink coolers



Beer tower TC Oltec

• Selected product version: TC Oltec ST3 Antique, gold

- Design: "T" / "H" (bar)
- Material: stainless steel
- Surface finish: polished/brushed stainless steel, titanium
- Special surface finish: epoxypolyester paint, maintenance-free surface finish with long-lasting resistance to external effects
- Ground coat: Antique gold, silver, copper, grey, or any color according to the customer's wishes
- Completely cooled up to the taps
- Number of taps in "T" design: 1 - 7
- Number of taps in "H" design: 3 - X
- Spacing between dispense taps: 140 mm
- Possibility of design with medallion holders on the body of the beer tower
- Including tower cooling for the beer line 6,7 x 9,5 mm

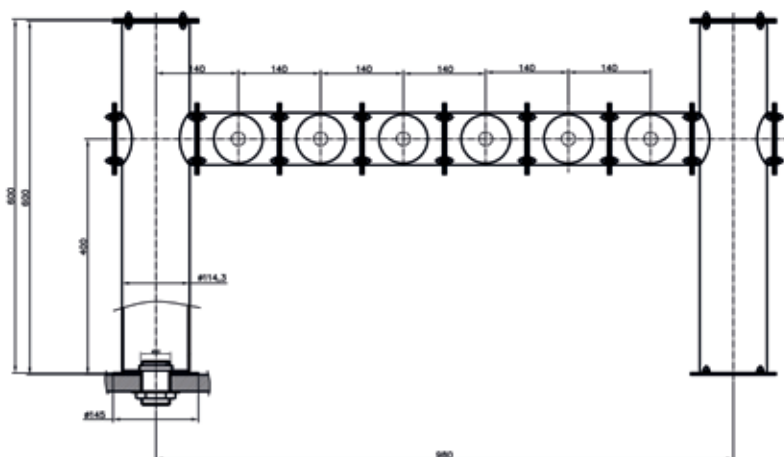

Dispense towers

Beer equipment
and drink coolers



stainless
steel

gloss

titanium

Beer tower TC Beethoven / bridge

- Selected product version: TC Beethoven ST4 titanium

- Material: stainless steel
- Surface finish: polished stainless steel, titanium
- Special surface finish: any color according to the customer's wishes
- Completely cooled up to the taps
- Number of taps: 2 - 7
- Spacing between dispense taps: 150 mm
- Possibility of design without medallion holders
- Including tower cooling for the beer line 6,7 x 9,5 mm / 9,5 x 12,7 mm

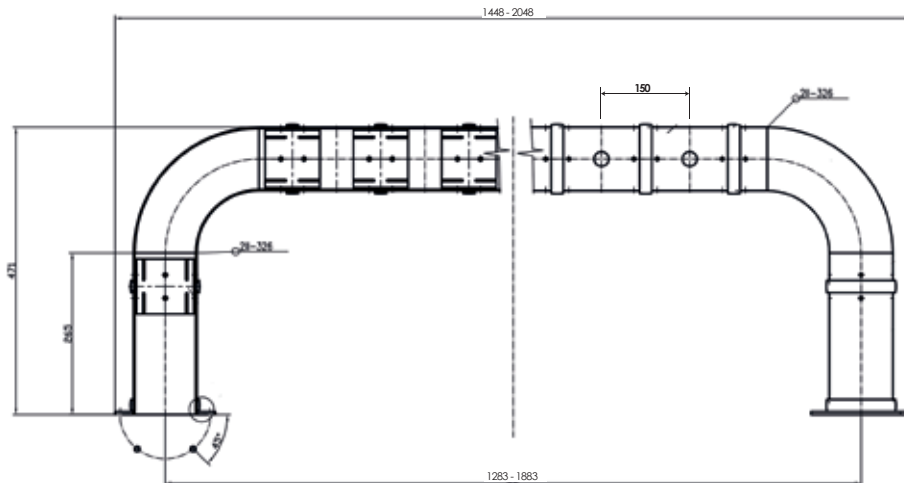

Dispense towers

Beer equipment
and drink coolers



stainless
steel

ground

titanium

Dispense towers

Beer equipment
and drink coolers



Beer tower TC Mozart

- Selected product version: TC Mozart ST3, brushed stainless steel
- Material: stainless steel
- Surface finish: brushed stainless steel, titanium
- Special surface finish: any color according to the customer's wishes
- Completely cooled up to the taps
- Number of taps: 2 – 7
- Spacing between dispense taps: 140 mm
- Mounting holes under dispense taps
- LED lighting
- Beer line 6,7 x 9,5 mm / 9,5 x 12,7 mm (only for 2 to 6 beer taps), with cooling coils

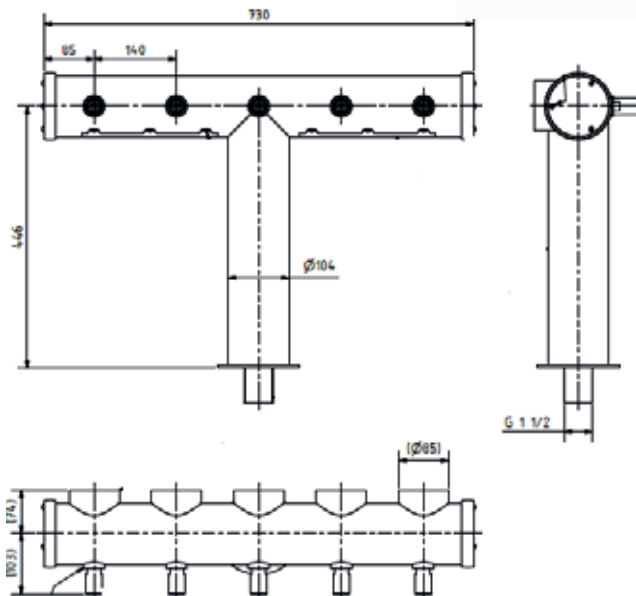



stainless
steel

gloss

ground

titanium

Dispense towers



Beer tower TC Sidewalk

- Selected product version: TC Sidewalk ST 4, brushed stainless steel
- Material: stainless steel
- Surface finish: polished/brushed stainless steel, titanium
- Special surface finish: any color according to the customer's wishes
- Completely cooled up to the taps
- Number of taps: 1 - 4
- Spacing between dispense taps: 140 mm
- Variant option with LED illumination of the center tube
- Mounting holes under dispense taps
- Including tower cooling for the beer line 6,7 x 9,5 mm

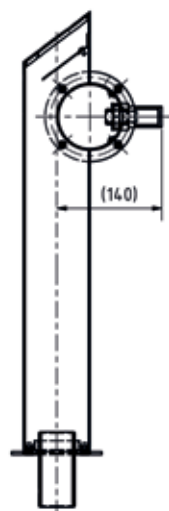
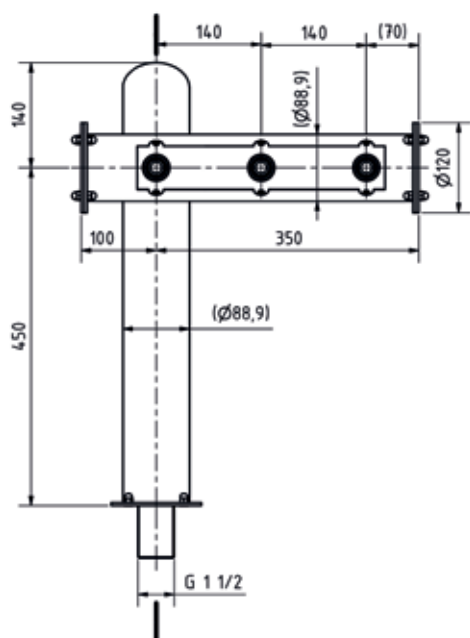

Beer tower TC Prisma

- Selected product version: TC Prisma ST1 glossy stainless steel

- Material: stainless steel
- Surface finish: polished/brushed stainless steel, titanium
- Special surface finish: galvanic copper plating or any color according to the customer's wishes
- Completely cooled up to the taps
- Number of taps: 1 - 2
- Variant option with LED illumination of the center tube
- Including tower cooling for the beer line 6,7 x 9,5 mm

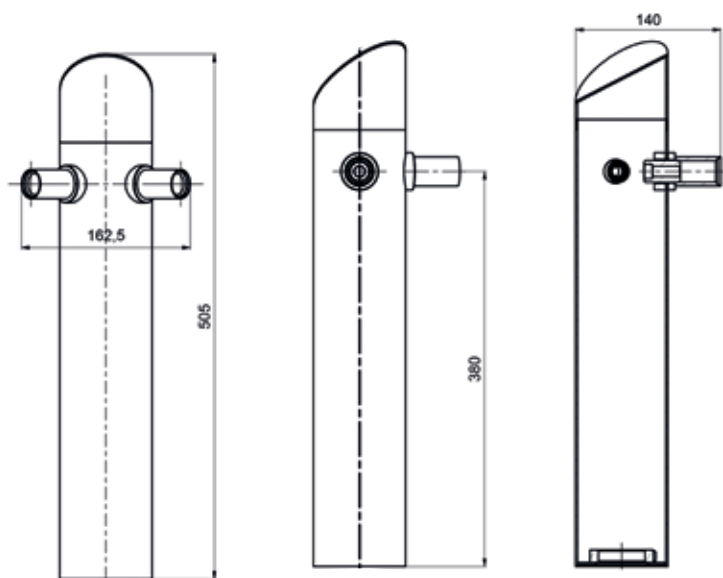

Dispense towers

Beer equipment
and drink coolers



stainless
steel

gloss

ground

Dispense towers



Beer tower Staropramen

- Selected product version: Staropramen ST 6, polished stainless steel
- Material: stainless steel
- Surface finish: polished/brushed stainless steel
- Cooled using a special aftercooling bar
- Number of taps: 4 – 6
- Spacing between dispense taps: 155 mm
- LED lighting
- Medailon holder behind the tap
- Including tower cooling for the beer line 6,7 x 9,5 mm / 9,5 x 12,7 mm
- Customized production for the Staropramen Brewery
- Registered industrial design

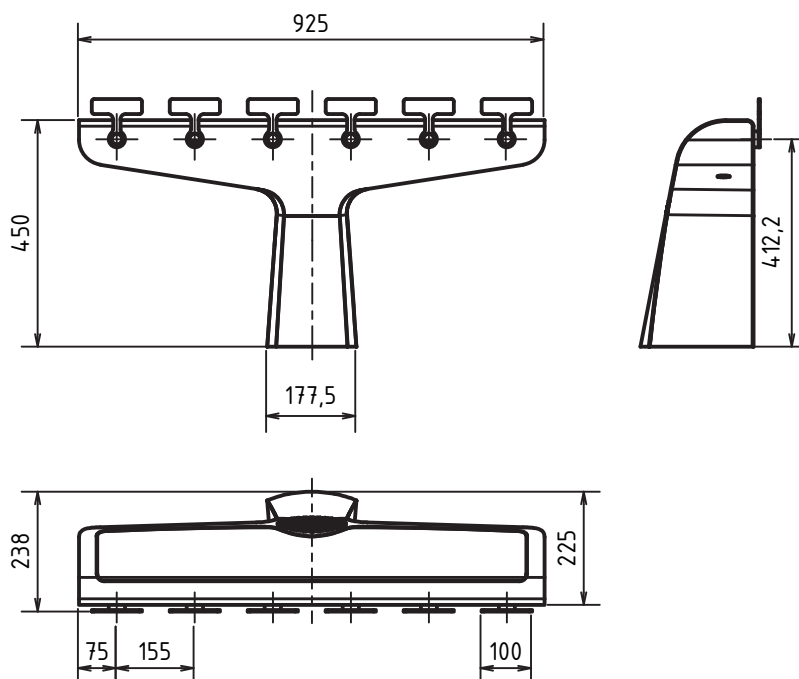



Beer tower Ostravar

- Selected product version: Ostravar ST 5, black matt
- Material: stainless steel
- Surface finish: polished/brushed stainless steel, black matt
- Cooled using a special aftercooling bar
- Number of taps: 5
- Spacing between dispense taps: 155 mm
- LED lighting
- Medailon holder behind the tap
- Including tower cooling for the beer line 6,7 x 9,5 mm / 9,5 x 12,7 mm
- Customized production for the Staropramen Brewery

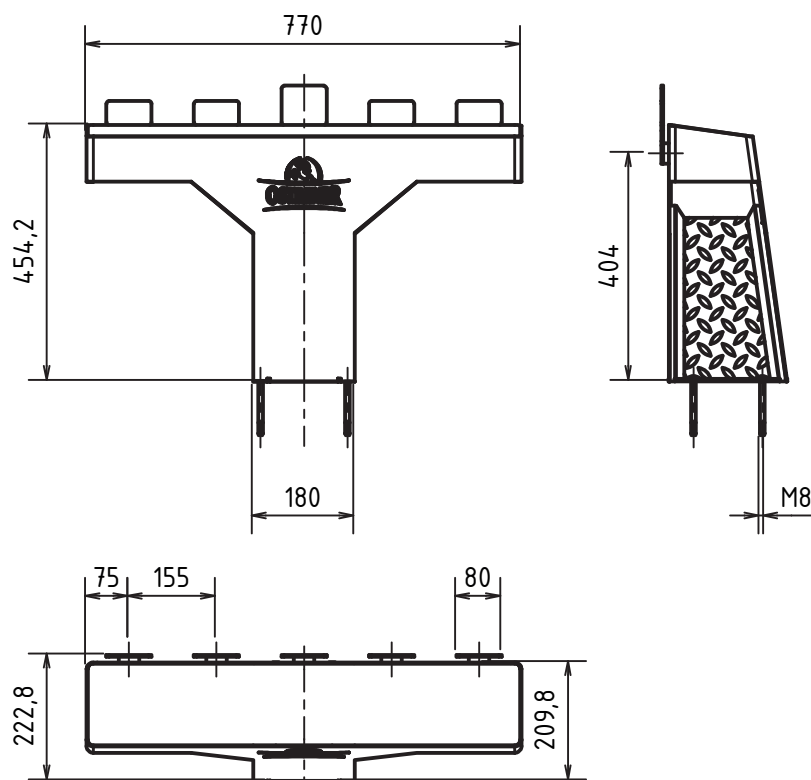

stainless
steel

ground

gloss

black
matt

Dispense towers

Beer equipment
and drink coolers



stainless
steel

ground

Dispense towers

Beer equipment
and drink coolers

Beer tower **Parlament**

- Selected product version: Parlament ST6, brushed stainless steel
- Material: stainless steel
- Surface finish: brushed stainless steel
- Number of taps: 6
- Spacing between dispense taps: 130 mm
- Including tower cooling for the beer line 6,7 x 9,5 mm
- Customized production for the Staropramen Brewery
- Registered industrial design

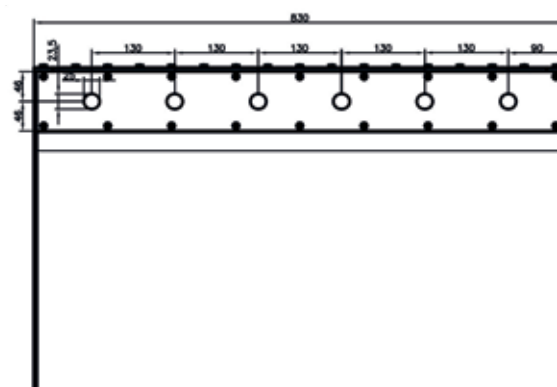
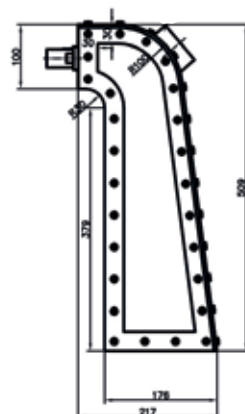



Beer tower TC Classic Must

• Selected product version: TC Classic Must ST3 polished stainless steel

- Material: stainless steel
- Surface finish: polished stainless steel, titanium
- Special surface finish: any color according to the customer's wishes
- Completely cooled up to the taps
- Number of taps: 1 - 4
- Spacing between dispense taps: ST2: 280 mm, ST3, ST4: 140 mm
- Illuminated LED medallion holders
- Including tower cooling for the beer line 6,7 x 9,5 mm
- Mounting holes under dispense taps

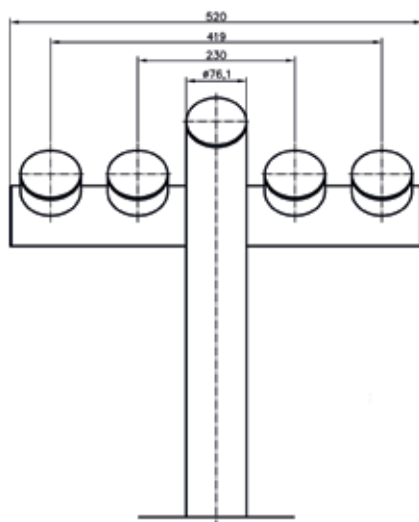
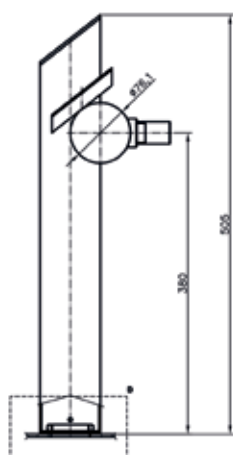

Dispense towers

Beer equipment
and drink coolers



stainless
steel

gloss

ground

titanium

Dispense towers



Beer tower TC Eva

- Selected product version: TC Eva ST4 titanium
- Material: stainless steel
- Surface finish: polished/brushed stainless steel, titanium
- Special surface finish: galvanic copper plating or any color according to the customer's wishes
- Completely cooled up to the taps
- Number of taps: 1 - 7
- Spacing between dispense taps: 140 mm (ST2: 280 mm)
- Mounting holes under dispense taps
- Illuminated LED taplite medallion holders
- Including tower cooling for the beer line 6,7 x 9,5 mm / 9,5 x 12,7 mm
- Customized production for the Heineken Brewery

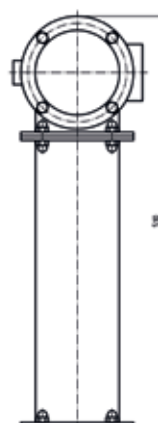
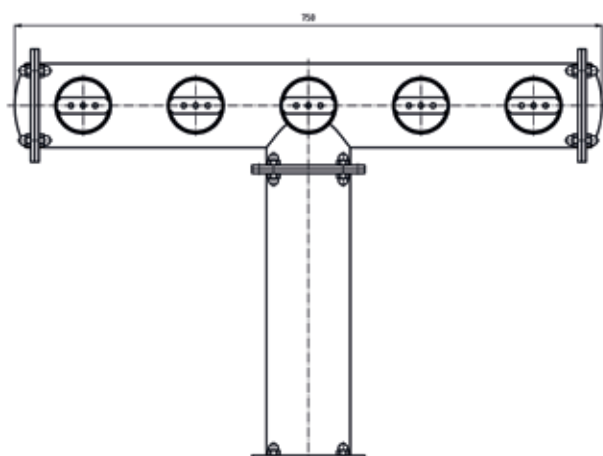



Beer tower **TC Tomanax**

- Selected product version: TC Tomanax ST6, stainless steel
- Material: stainless steel
- Surface finish: polished/brushed stainless steel, titanium
- Special surface finish: galvanic copper plating or any color according to the customer's wishes
- Completely cooled up to the taps
- Number of taps: 2 – 7
- Spacing between dispense taps: 150 mm
- Medallion holders on the body of the tower or can be placed behind the tap
- Beer line 6,7 x 9,5 mm / 9,5 x 12,7 mm (only for 2 to 6 beer taps), with cooling coils

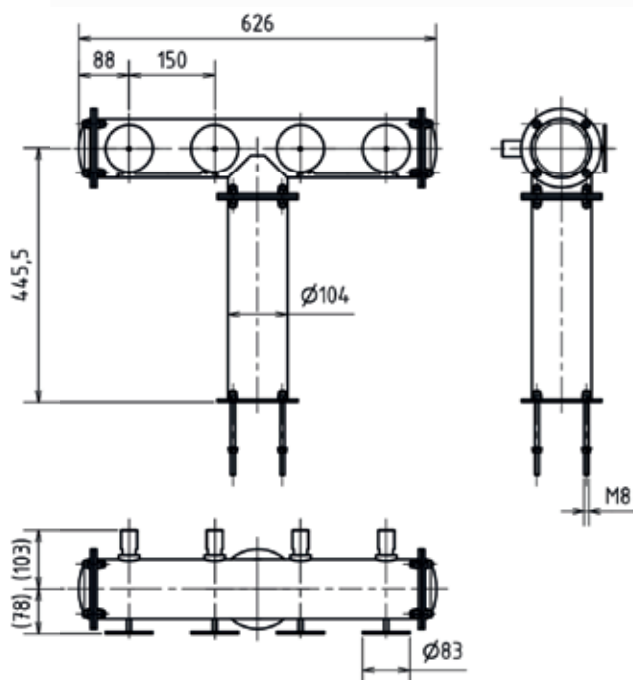

- possibility of design also in Tomanax 2T version (for more than 7 beer taps)



stainless
steel

gloss

ground

titanium

swept
copper

Dispense towers

Beer equipment
and drink coolers



brass

gloss

titanium



Beer tower Iron

- Selected product version: Iron ST3 chromium
- Material: brass
- Surface finish: chromium, titanium
- Number of taps: 1 - 4
- Including tower cooling for the beer line + cooling loop

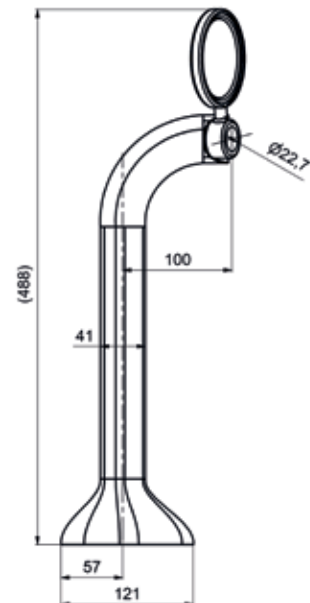
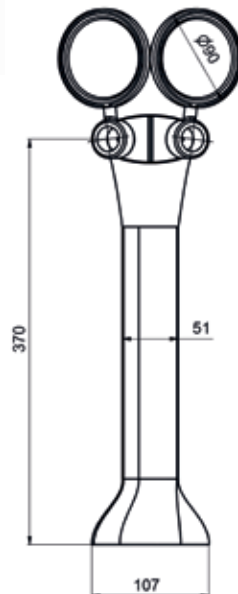

Beer tower TC Sprig

• Selected product version: TC Sprig ST2 polished stainless steel

- Material: stainless steel
- Surface finish: polished stainless steel, titanium
- Number of taps: 1 - 2
- Beer lines 6,7 x 9,5 mm
- Inox cooling coil
- Possibility to place medal holders behind the dispense taps
- Diameter of the fittings for mounting the tower: G 1-1/2

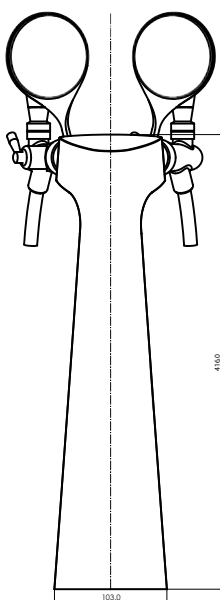
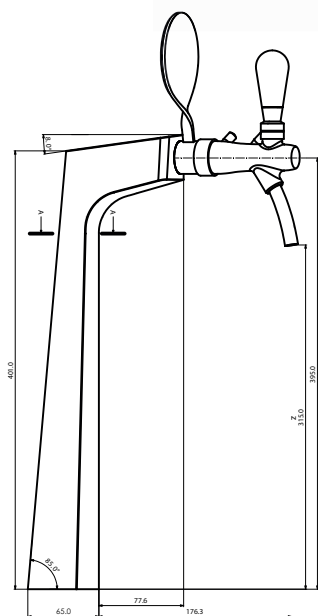

stainless
steel

gloss

titanium

swept
copper

black
matt

Dispense towers

Beer equipment
and drink coolers



ceramics
green

Dispense towers



ceramics
green/
white



Beer tower Krakonoš

- Selected product version: Ceramic tower Krakonoš ST3
- Material: glazed ceramics
- Number of taps: 1 - 3
- Including tower cooling for the beer line: 6,7 x 9,5 mm + cooling loop
- Customized production for the Krakonoš Brewery



Beer tower Holba

- Selected product version: Ceramic tower Holba ST4
- Material: glazed ceramics
- Number of taps: 1 - 4
- Including tower cooling for the beer line: 6,7 x 9,5 mm + cooling loop
- Customized production for the Holba Brewery



Beer tower Majolika

- Selected product version: Majolika ST6, titanium
- Material: ceramics, stainless steel
- Surface finish: polished stainless steel, titanium, glazed ceramics
- Number of taps:
 - 1 - 6
 - 1 - 2 circular balcony
 - 3 - 6 oval balcony
- Spacing between dispense taps: ST3: 135mm, ST4,5,6: 90mm
- Including tower cooling for the beer line 6,7 x 9,5 mm
- Customized production for the Budejovický Budvar Brewery



Beer tower Černá Hora

- Selected product version: Černá Hora ST5, titanium
- Material: ceramics, stainless steel
- Surface finish: polished stainless steel, titanium, glazed ceramics
- Number of taps: 2 - 5
- Including tower cooling for the beer line 6,7 x 9,5 mm + cooling loop
- Customized production for the Černá Hora Brewery



Dispense towers





TC HALM



STAROPRAMEN



TC OLTEC



TC BERANY



OSTRAVAR



TC CLASSIC MUST



TC BEETHOVEN / BRIDGE



TC TOMANAX



TC SPRIG



TC MOZART



TC PRISMA



TC BRAUHAUS L



TC EVA



TC BRAUHAUS



TC SIDEWALK



Dispense tap Felom chromium, golden

Dispense tap with compensator made of chrome plated brass. Thread length 35mm - 5/8", a special version 5/8" x 47/55/65 mm is also available.



Dispense tap chromium, golden, stainless steel

Dispense tap with compensator in chromium, titanium (golden) or stainless steel design. Thread length 35 mm, 55 mm - 5/8".



Dispense tap Sparkler chromium, golden

Dispense tap Sparkler with compensator in chromium or golden design. Thread length 35mm - 5/8".

Dispense tap Nostalgie stainless steel, golden

Dispense tap Nostalgie with compensator in stainless steel (chromium) or titanium (golden) design.
Thread length 35 mm - 5/8". Handle – imitation of wood.



Dispense tap Baroko stainless steel, golden

Dispense tap Baroko with compensator in stainless steel or titanium (golden) design.
Thread length 35 mm. Handle – imitation of wood.



Dispense tap Royal stainless steel, golden

Dispense tap ROYAL with compensator, rotating ball construction, made of polished stainless steel.
Thread length: 5/8"x40x10.
Handle standard black plastic or wood imitation.
With removable nozzle with strainer.



Round medal for dispense tap - chromium, titanium



Round medal for dispense tap (long version) - chromium, titanium



Gasket kits for dispense taps (by the type of the dispense tap)





wood

Wine tap

Beer equipment
and drink coolers



Wooden front

- Material: wood
- Design: circle/oval
- Dimensions: upon customer's request
- Logo or artistic carving can be engraved on the vintner's front

Wine dispensing scheme

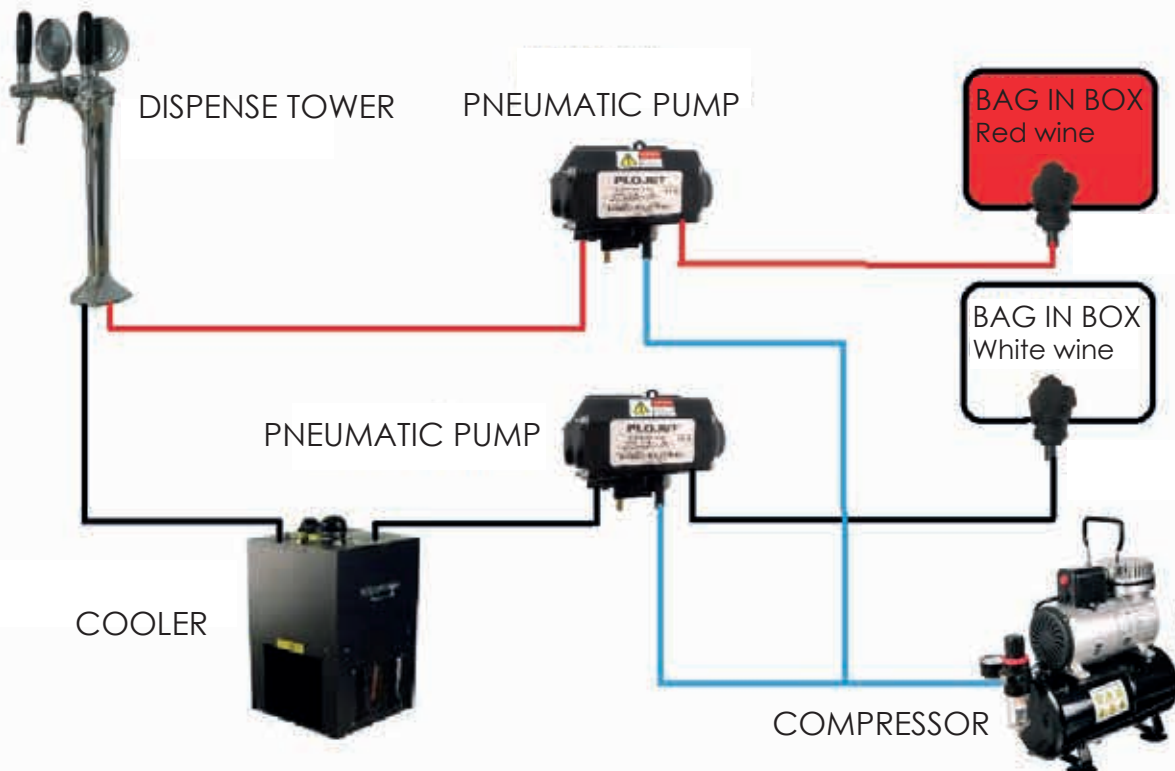

BKG 25/28 L - ECO

Water cooler BKG 25/28 L-ECO with cooling of the beer line. Professional cooler with high quality processing and high power. Small dimensions and easy installation.

- Dimensions (w×d×h): 700x390x350 mm
- Design: horizontal
- Compressor power: 1/4 HP
- Voltage: 230V/50 Hz
- Water tank capacity: 21 l
- Cooling power: 550 W
- Refrigerant: R290
- Ice bank: 5-13 kg
- Beer dispense: 60 l/h
- Number of beer coils: 1-3

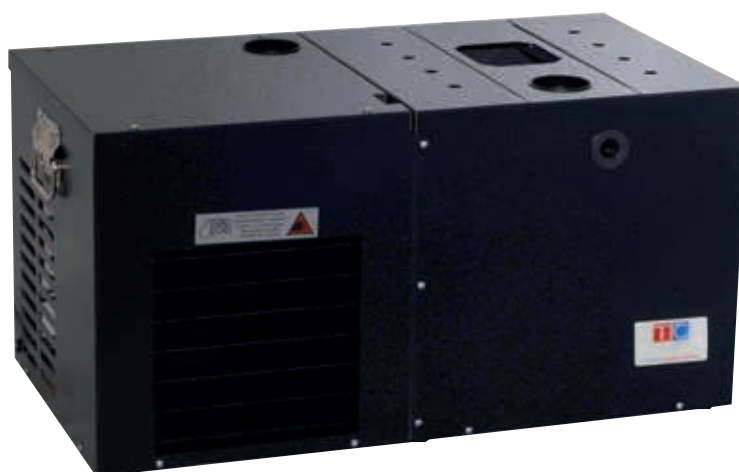

BKG 25/28 S - ECO

Water cooler BKG 25/28 S-ECO with cooling of the beer line. Professional cooler with high quality processing and high power. Small dimensions and easy installation.

- Dimensions (w×d×h): 380x400x580 mm
- Design: vertical
- Compressor power: 1/4 HP
- Voltage: 230V/50 Hz
- Water tank capacity: 21 l
- Cooling power: 550 W
- Refrigerant: R290
- Ice bank: 5-13 kg
- Beer dispense: 60 l/h
- Number of beer coils: 1-3



BKG 38/40 S - ECO

Water cooler BKG 38/40 S-ECO with cooling of the beer line. Professional cooler with high quality processing and high power. Easy installation.

- Dimensions (w×d×h): 430x440x620 mm
- Design: vertical
- Compressor power: 3/8 HP
- Voltage: 230V/50 Hz
- Water tank capacity: 31 l
- Cooling power: 750 W
- Refrigerant: R290
- Ice bank: 12-16 kg
- Beer dispense: 90 l/h
- Number of beer coils: 1-4



BKG 50/40 S - ECO

Water cooler BKG 50/40 S-ECO with cooling of the beer line. Professional cooler with high quality processing and high power. Easy installation.

- Dimensions (w×d×h): 430x440x650 mm
- Design: vertical
- Compressor power: 1/2 HP
- Voltage: 230V/50 Hz
- Water tank capacity: 31 l
- Cooling power: 1200 W
- Refrigerant: R290
- Ice bank: 12-16 kg
- Beer dispense: 140 l/h
- Number of beer coils: 1-6



BKG 50/54 L - ECO

Water cooler BKG 50/54 L-ECO with cooling of the beer line. Professional cooler with high quality processing and high power. Easy installation.

- Dimensions (w×d×h): 800x440x500 mm
- Design: horizontal
- Compressor power: 1/2 HP
- Voltage: 230V/50 Hz
- Water tank capacity: 46 l
- Cooling power: 1200 W
- Refrigerant: R290
- Ice bank: 15-27 kg
- Beer dispense: 140 l/h
- Number of beer coils: 1-6

BKG 50/74 S - ECO

Water cooler BKG 50/74 S-ECO with cooling of the beer line. Professional cooler with high quality processing and high power. Easy installation.

- Dimensions (w×d×h): 530x560x700 mm
- Design: vertical
- Compressor power: 1/2 HP
- Voltage: 230V/50 Hz
- Water tank capacity: 58 l
- Cooling power: 1200 W
- Refrigerant: R290
- Ice bank: 18-28 kg
- Beer dispense: 140 l/h
- Number of beer coils: 1-6



BKG 75/90 S - ECO

Water cooler BKG 75/90 S-ECO with cooling of the beer line. Professional cooler with high quality processing and high power. Easy installation.

- Dimensions (w×d×h): 600x590x820 mm
- Design: vertical
- Compressor power: 3/4 HP
- Voltage: 230V/50 Hz
- Water tank capacity: 87 l
- Cooling power: 1500 W
- Refrigerant: R290
- Ice bank: 27-38 kg
- Beer dispense: 160 l/h
- Number of beer coils: 1-6





BKG 75/137 L - ECO

Water cooler BKG 75/137 L-ECO with cooling of the beer line. Professional cooler with high quality processing and high power.

- Dimensions (w×d×h): 1230x590x500 mm
- Design: horizontal
- Compressor power: 3/4 HP
- Voltage: 230V/50 Hz
- Water tank capacity: 150 l
- Cooling power: 1500 W
- Refrigerant: R290
- Ice bank: 29-46 kg
- Beer dispense: 160 l/h
- Number of beer coils: 1-12



BKG 50/54 L-D Spec.VK - ECO

Water cooler BKG 50/54 L-D Spec.VK-ECO with dispense taps including cooling of the beer line. Professional cooler with high quality processing and high power. Easy installation. Direct dispensing from the cooler. The set contains two dispense taps and compensator.

- Dimensions (w×d×h): 800x440x500 mm
- Design: horizontal
- Compressor power: 1/2 HP
- Voltage: 230V/50 Hz
- Water tank capacity: 31 l
- Cooling power: 1200 W
- Refrigerant: R290
- Ice bank: 12-16 kg
- Beer dispense: 140 l/h
- Number of beer coils: 1 -2 incl. 2 dispense taps

PYGMY 20/K Green Line - Countertop beer cooler with built-in air compressor

• External dimensions:	170 x 280 x 325 mm
• Cooling compressor power:	1/8 Hp
• Refrigeration range:	2 - 8 °C
• Cooling coil length:	11,5 m
• Voltage:	220-240 V
• Power input:	322 W
• Output:	20 l/h max. 25 l/h
• Refrigerant:	R290
• Weight:	15,5 kg
• Number of coils:	1 pcs
• Supply:	1,40 A



PYGMY 25 Green Line - Countertop beer cooler

• External dimensions:	170 x 280 x 325 mm
• Cooling compressor power:	1/8 Hp
• Refrigeration range:	2 - 8 °C
• Cooling coil length:	10,5 m
• Voltage:	220-240 V
• Power input:	299 W
• Output:	25 l/h max. 35 l/h
• Refrigerant:	R290
• Weight:	14,5 kg
• Number of coils:	1 pcs
• Supply:	1,30 A



PYGMY 25/K Green Line - Countertop beer cooler with built-in air compressor

• External dimensions:	170 x 280 x 325 mm
• Cooling compressor power:	1/8 Hp
• Refrigeration range:	2 - 8 °C
• Cooling coil length:	10,5 m
• Voltage:	220-240 V
• Power input:	368 W
• Output:	25 l/h max. 35 l/h
• Refrigerant:	R290
• Weight:	16,4 kg
• Number of coils:	1 pcs
• Supply:	1,60 A



KONTAKT 40 Green line - Countertop beer cooler

•External dimensions:	225 x 330 x 425 mm
•Cooling compressor power:	1/5 Hp
•Refrigeration range:	2 - 8 °C
•Cooling coil length:	14/14 m
•Voltage:	220-240 V
•Power input:	322 W
•Output:	40 l/h max. 50 l/h
•Refrigerant:	R290
•Weight:	26 kg
•Number of coils:	2 pcs
•Supply:	1,40 A

KONTAKT 40/K Green line - Countertop beer cooler with built-in air compressor

•External dimensions:	225 x 330 x 425 mm
•Cooling compressor power:	1/5 Hp
•Refrigeration range:	2 - 8 °C
•Cooling coil length:	14/14 m
•Voltage:	220-240 V
•Power input:	391 W
•Output:	40 l/h max. 50 l/h
•Refrigerant:	R290
•Weight:	29 kg
•Number of coils:	2 pcs
•Supply:	1,70 A



KONTAKT 40/K Profi Green line - Countertop beer cooler with built-in air compressor and manometer

•External dimensions:	225 x 330 x 425 mm
•Cooling compressor power:	1/5 Hp
•Refrigeration range:	2 - 8 °C
•Cooling coil length:	14/14 m
•Voltage:	220-240 V
•Power input:	391 W
•Output:	40 l/h max. 50 l/h
•Refrigerant:	R290
•Weight:	29 kg
•Number of coils:	2 pcs
•Supply:	1,70 A

KONTAKT 70 Green line - Countertop beer cooler

•External dimensions:	245 x 340 x 440 mm
•Cooling compressor power:	1/3 Hp
•Refrigeration range:	2 - 8 °C
•Cooling coil length:	14/14 m
•Voltage:	220-240 V
•Power input:	506 W
•Output:	70 l/h max. 90 l/h
•Refrigerant:	R290
•Weight:	27,5 kg
•Number of coils:	2 pcs
•Supply:	2,20 A

KONTAKT 70/K Green line - Countertop beer cooler with built-in air compressor

•External dimensions:	245 x 340 x 440 mm
•Cooling compressor power:	1/3 Hp
•Refrigeration range:	2 - 8 °C
•Cooling coil length:	14/14 m
•Voltage:	220-240 V
•Power input:	598 W
•Output:	70 l/h max. 90 l/h
•Refrigerant:	R290
•Weight:	29,5 kg
•Number of coils:	2 pcs
•Supply:	2,60 A



KONTAKT 155 Green Line - Countertop beer cooler

•External dimensions:	265 x 380 x 495 mm
•Cooling compressor power:	3/4 Hp
•Refrigeration range:	2 - 8 °C
•Cooling coil length:	26/26 m
•Voltage:	220-240 V
•Power input:	874 W
•Output:	120 l/h max. 160 l/h
•Refrigerant:	R290
•Weight:	39,5 kg
•Number of coils:	2 pcs
•Supply:	3,80 A

KONTAKT 155/K Green Line - Countertop beer cooler with built-in air compressor

•External dimensions:	265 x 380 x 495 mm
•Cooling compressor power:	3/4 Hp
•Refrigeration range:	2 - 8 °C
•Cooling coil length:	26/26 m
•Voltage:	220-240 V
•Power input:	966 W
•Output:	120 l/h max. 160 l/h
•Refrigerant:	R290
•Weight:	42 kg
•Number of coils:	2 pcs
•Supply:	4,20 A



FlexiDraft™ is a concept targeted to provide a cost effective solution for the dispense of draught beers, ciders and wines in small and medium size outlets. The One-Way Beer Line fits all standard keg connections. The most significant benefits of this beer system include:

- Its unique disposable One-Way Beer Line means no cleaning and no maintenance.
- It also extends the fresh life of beer in a broached keg from 6 to 30 days.
- Once a keg is empty, you simply dispose of the patented One-Way Beer Line, fit a new one and you are ready to go.

This complete set includes a cooler for barrels, a draft stand without lighting, controller, a keg head, a stainless steel top plate with integrated drip tray. Available with a range of optional accessories including interior lighting and door lock.

- Temperature range: +2 ... +4 °C
- Voltage: 230 V/50 Hz
- Rated power: 406 W
- Noise: 48-55 dB
- Refrigerant: R290



Star 10 - Complete beer system

- Beer tower: 1 pcs
- External dimensions: 640 x 617 x 978 mm
- Weight: 63 kg
- Consumption: 2,2 kWh
- Internal size: 500 x 400/260 x 690/540 mm
- KEG capacity: 2 x 20l slim / 1 x 30l



Star 15 - Complete beer system

- Beer tower: 1-2 pcs
- External dimensions: 650 x 680 x 996/1083 mm
- Weight: 73 kg
- Consumption: 2,8 kWh
- Internal size: 530 x 550 x 636 mm
- KEG capacity: 4 x 20l slim / 1 x 30l / 1 x 50l



Star 20 - Complete beer system

- Beer tower: 1-2 pcs
- External dimensions: 950 x 640 x 987 mm
- Weight: 88 kg
- Consumption: 2,4 kWh
- Internal size: 590 x 510 x 755 mm
- KEG capacity: 4 x 20l slim / 2 x 20l / 1 x 30l / 1 x 50l



Star 25 - Complete beer system

- Beer tower: 1-2 pcs
- External dimensions: 736 x 778 x 1015/1102 mm
- Weight: 84,5 kg
- Consumption: 2,8 kWh
- Internal size: 500 x 610 x 640 mm
- KEG capacity: 4 x 20l slim / 2 x 30l / 1 x 50l

Star 30 - Complete beer system

- Beer tower: 1-3 pcs
- External dimensions: 1230 x 640 x 987 mm
- Weight: 105 kg
- Consumption: 2,6 kWh
- Internal size: 870 x 510 x 755 mm
- KEG capacity: 6 x 20l slim / 2 x 30l / 2 x 50l

Star 40 - Complete beer system

- Beer tower: 1-4 pcs
- External dimensions: 1520 x 700 x 1070 mm
- Weight: 150 kg
- Consumption: 5,4 kWh
- Internal size: 2x500 x 570 x 858 mm
- KEG capacity: 8 x 20l slim / 4 x 30l / 2 x 50l

TC KEGNS2 - KEG cooler

- External dimensions: 1065 x 710 x 1080 mm
- Internal dimensions: 980 x 615 x 980 mm
- KEG capacity: 8x20l / 4x30l / 2x50l
- Net volume: 590 l

TC KEGNS4 - KEG cooler

- External dimensions: 1065 x 975 x 1080 mm
- Internal dimensions: 980 x 885 x 980 mm
- KEG capacity: 12x20l / 8x30l / 4x50l
- Net volume: 850 l

TC KEGNS6 - KEG cooler

- External dimensions: 1470 x 975 x 1080 mm
- Internal dimensions: 1385 x 885 x 980 mm
- KEG capacity: 18x20l / 12x30l / 6x50l
- Net volume: 1200 l

TC KEGNS8 - KEG cooler

- External dimensions: 1875 x 975 x 1080 mm
- Internal dimensions: 1790 x 885 x 980 mm
- KEG capacity: 21x20l / 16x30l / 8x50l
- Net volume: 1550 l

TC KEGNS10 - KEG cooler

- External dimensions: 2205 x 975 x 1080 mm
- Internal dimensions: 2120 x 885 x 980 mm
- KEG capacity: 24x20l / 20x30l / 10x50l
- Net volume: 1830 l

TC RU - Top cooling unit

- External dimensions: 615 x 525 x 365/405 mm
- Power input: 300 W
- Refrigeration range: +2 ... +10 °C
- Refrigerant: R290

TC RU 50 - Side cooling unit

- External dimensions: 355/400 x 560 x 855 mm
- Power input: 670 W
- Refrigeration range: +2 ... +10 °C
- Refrigerant: R290

- Exterior surface finish: anthracite
- Interior surface finish: silver (bottom: stainless steel (AISI 304, 18/10))
- Separate plug ready machine unit
- Easy installation in narrow spaces like cellars
- The keg cooler comes flat packed with a separate plug ready machine unit
- Ready to use
- Cooling by fan with quick cooling effect
- Higher cooling power with 35% less energy consumption
- Simple service - completely removable cooling unit
- Electronic thermostat with automatic defrost
- Reinforced stainless steel bottom panels
- Environment friendly refrigerant
- Easy connection of beer hoses with tap through to pre-drilled holes on both sides of the device





DFK-2E - KEG cooler

- External dimensions: 625x580x860 mm
- Power input: 300 W
- Refrigeration range: +2 ... +10 °C
- KEG capacity: 2x20 l
- Refrigerant: R290
- Weight: 45 kg
- Voltage: 220-240 V/ 50 Hz



DFK-4E - KEG cooler

- External dimensions: 885x580x860 mm
- Power input: 300 W
- Refrigeration range: +2 ... +10 °C
- KEG capacity: 4x20/1x50 l
- Refrigerant: R290
- Weight: 50 kg
- Voltage: 220-240 V/ 50 Hz



DFK-6E - KEG cooler

- External dimensions: 1115x580x860 mm
- Power input: 300 W
- Refrigeration range: +2 ... +10 °C
- KEG capacity: 6x20/2x20+1x50 l
- Refrigerant: R290
- Weight: 55 kg
- Voltage: 220-240 V/ 50 Hz



DFK-8E - KEG cooler

- External dimensions: 1355x580x860 mm
- Power input: 300 W
- Refrigeration range: +2 ... +10 °C
- KEG capacity: 8x20/4x20+1x50/2x50 l
- Refrigerant: R290
- Weight: 60 kg
- Voltage: 220-240 V/ 50 Hz

- simple service – completely removable cooling unit (aggregate), exchanged within 15 minutes
- reinforced bottom panel
- electronic thermostat with automatic defrost
- easy connection of beer hoses with tap through to pre-drilled holes on both sides of the device
- inner LED light
- ventilated cooling (quick cooling effect)



THERMOTECHNIKA CROWN COOL

Dolium

One-Way PET Kegs



Dolium One-Way PET Kegs

- Plastic alternative to stainless steel kegs
- Suitable for filling beer, wine, ciders, cold coffee, kombucha, and other enhanced beverage
- 100% recyclable - lowest ecological trace of all kegs
- Significant cost savings, no investment costs
- Easy handling and stackability, significant logistical savings
- Plastic kegs arrive clean, dry, sterile and ready to fill
- Variable filling - bottom, top, automatic, semi-automatic, manual
- Compatible with existing dispense heads, connector types: S, A, G
- Integrated pressure relief valve
- Filled with CO2 under pressure
- Lifetime: 600 days from date of production
- Variants: 12,5 l, 20 l, 30 l



100% recyclable

Financially beneficial

Variants:

- 12,5 l
- 20 l
- 30 l



Dolium kegs

Beer equipment
and drink coolers



**THERMOTECHNIKA
CROWN COOL**

Beverage accessories

KEG Couplers
Pressure reducers
Compressors
Glass washers
Drip trays / Pythons & tubing
Cooler accessories
Sanitation



A-system Flach

Dispense head Flach – outlets 5/8"

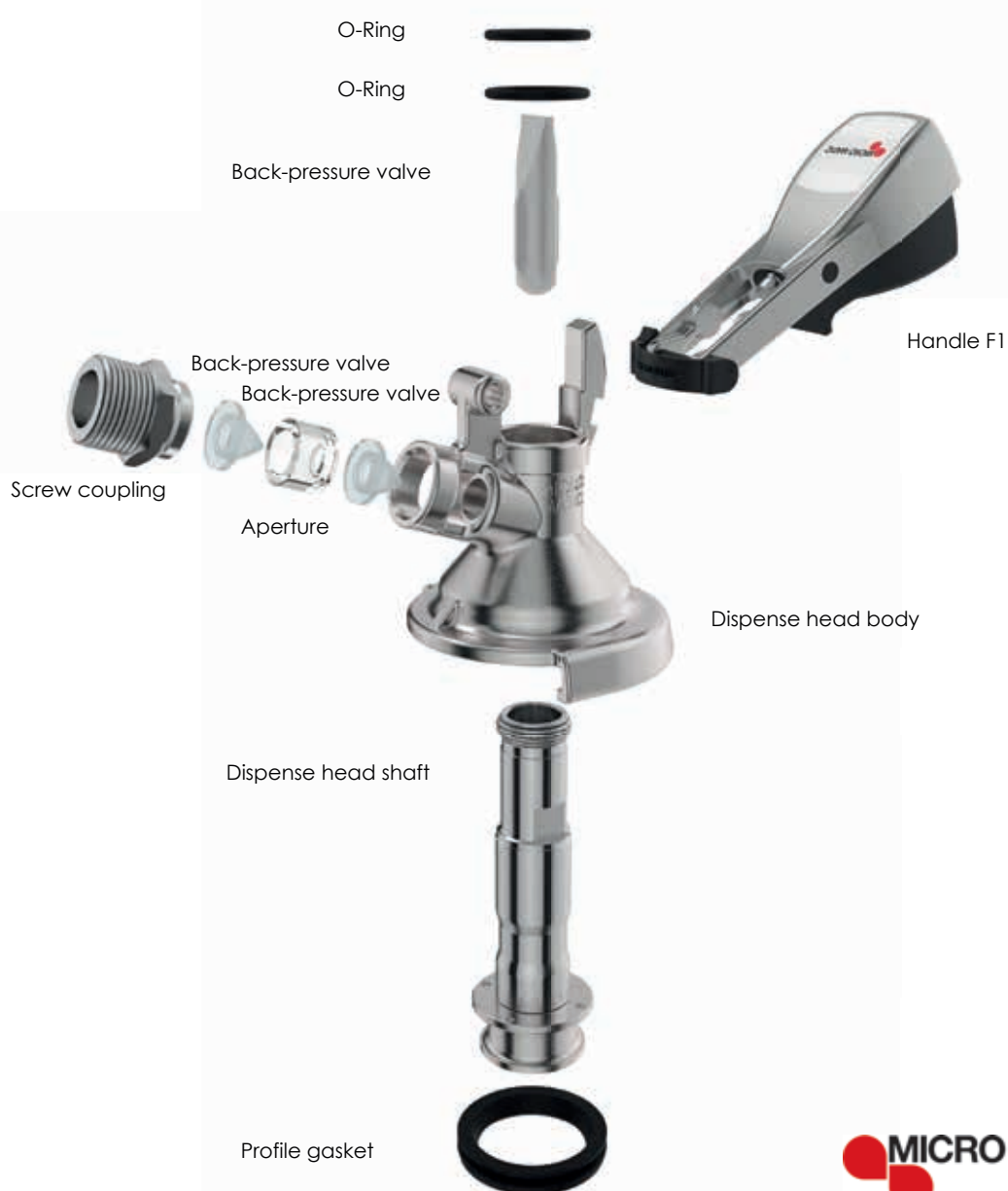



M-system **Kombi**
Dispense head Kombi – outlets 5/8"

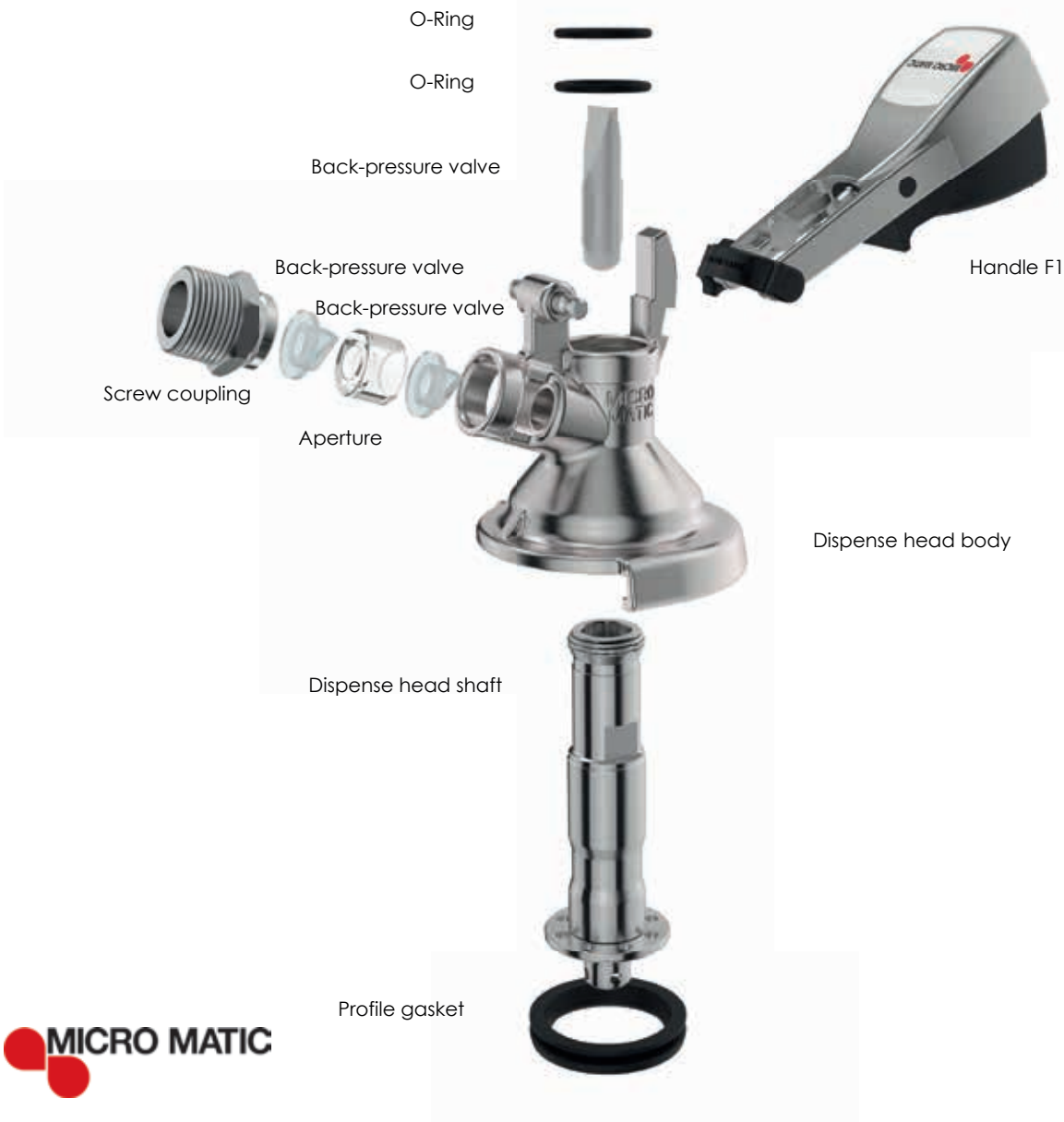

S-system Korb

Dispense head Korb – outlets 5/8"

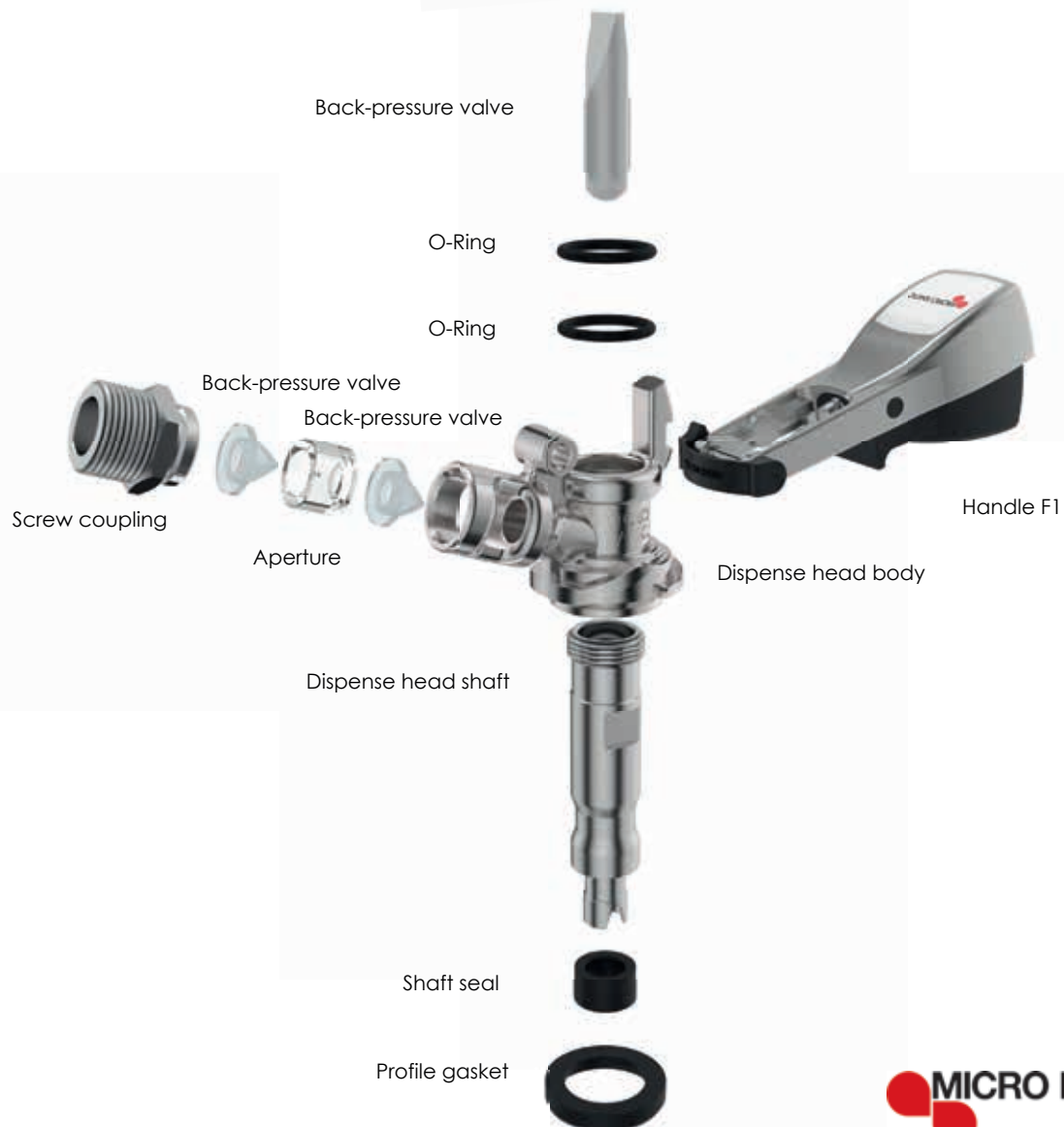



Pressure reducer 1403 for CO2 0-6/3bar

- PR 1403 one-outlet pressure reducer for CO2
- 0-6/3 bar with single outlet
- PREMIUM PLUS screw coupling 3/4

Pressure reducer 1403 for CO2 0-6/4bar

- PR 1403 one-outlet pressure reducer for CO2
- 0-6/4 bar with single outlet
- PREMIUM PLUS screw coupling 1/2

Pressure reducer 1403 for CO2 0-10/7 bar

- PR 1403 one-outlet pressure reducer for CO2
- 0-10/7 bar with single outlet
- PREMIUM PLUS screw coupling 3/4



Pressure reducer 1410 for nitrogen 0-6/3 bar

- PR 1410 one-outlet pressure reducer for nitrogen
- 0-6/3 bar with single outlet
- PREMIUM PLUS screw coupling 3/4

Pressure reducer 1410 for nitrogen 0-6/4 bar

- RV 1410 one-outlet pressure reducer for nitrogen
- 0-6/4 bar with single outlet
- PREMIUM PLUS screw coupling 1/2



Secondary beer regulator type 18

Single-outlet secondary beer regulator 0-6/4 bar without safety valve provided with main closing outlet – PREMIUM PLUS



Pressure reducer for N2 (nitrogen) double gauge Premium+ 0-6/4 bar

- Pressure reducer for N2 (nitrogen) double tap Premium+ 0-6/4 bar
- 2x separately adjustable outlet pressures 0-4 bar
- Screw coupling 1/2"



Pressure reducer for CO2 double gauge Premium+ 0-6/4 bar

- Pressure reducer for CO2 double tap Premium+ 0-6/4 bar
- 2x separately adjustable outlet pressures 0-4 bar
- Screw coupling 1/2"



Pressure reducer for nitrogen, two-outlet 0-10/6 bar

- Pressure reducer for N2, two-outlet / double tap, 0-10/6 bar.
- Separately adjustable outlet pressures.
- Screw coupling 1/2.

Pressure reducer for CO2, two-outlet 0-10/6 bar

- Pressure reducer for CO2, two-outlet / double tap, 0-10/6 bar.
- Separately adjustable outlet pressures.
- Screw coupling 1/2.



Pressure reducer for nitrogen, three-outlet 0-10/6 bar

- Pressure reducer for N2, three-outlet / triple tap, 0-10/6 bar.
- Separately adjustable outlet pressures.
- Screw coupling 1/2.

Pressure reducer for CO2, three-outlet 0-10/6 bar

- Pressure reducer for CO2, three-outlet / triple tap, 0-10/6 bar.
- Separately adjustable outlet pressures.
- Screw coupling 1/2.



Puma MC 5606 - portable compressor

Portable compressor of professional series with automatic operation. It belongs in the group of oil-free compressors that can be used in food industry.

- Flow rate 47 l / min.
- Noise level 69 dB
- Maximum pressure 8 bar
- Tank capacity 6 l
- Weight 12 kg
- Dimensions (w × d × h) - 470 x 180 x 420 mm
- Long service life



Leonardo - portable compressor

Automatic operation, portable. It belongs in the group of oil-free compressors that can be used in food industry.

- Flow rate 105 l / min.
- Noise level 85 dB
- Maximum pressure 8 bar
- Tank capacity 8 l
- Weight 17 kg
- Dimensions (w × d × h) - 430 x 190 x 430 mm
- Long service life



Puma MC 7523 - portable compressor

Automatic operation, portable. It belongs in the group of oil-free compressors that can be used in food industry.

- Flow rate 72 l / min.
- Noise level 72 dB
- Maximum pressure 7 bar
- Tank capacity 23 l
- Weight 23 kg
- Dimensions (w × d × h) - 580 x 350 x 500 mm
- Long service life



Glass washer Delfin TS 2000

Appliance for washing glasses achieves top washing effect with minimum time and power costs; it only utilizes water pressure. Water savings comparing to regular manual glass washing.

Beer glass washer Dunetic

Compact manual glass washer Dunetic allows washing that utilizes water pressure, has zero power demands and represents up to 70% water savings comparing to regular washing in sink.

Spare parts to beer glass washer





Dip tray - stainless steel 340 x 200 mm
 Dip tray - stainless steel 600 x 220 mm
 Dip tray - stainless steel 450 x 220 mm
 Dip tray - stainless steel 800 x 250 mm



Dip tray - gold 340 x 200 mm
 Dip tray - gold 450 x 220 mm
 Dip tray - gold 600 x 220 mm



Python including tower cooling for the beer line 6,7 x 9,5 mm and tower cooling for the beer line 9,5 x 12,7 mm



Python including tower cooling for the beer line and final cooling 6,7 x 9,5 mm



Beer tubes for John Guest
 6,7 x 9,5 mm / 9,5 x 12,7 mm

John Guest connectors





Stainless cooling loop with 8 mm / 9,5 mm outer pipe diameter



Motor whirler with pump MID-7

Motor whirler with pump to 6 m type MID-7.



Motor whirler with pump STB 12

Motor whirler with pump to 11 m/ type TOTTON STB 12.



Motor whirler with pump RIO 7

Motor whirler with pump to 6 m type RIO-7.

Spare parts to coolers



Cleaning drum FLACH / KOMBI / KORB 5l with stainless steel spears



Flow cleaning adapter FLACH / KOMBI / KORB



Spare parts for sanitation





THERMOTECHNIKA CROWN COOL



Spears

THERMOTECHNIKA BOHEMIA is an exclusive supplier of spears of company Micro Matic in the Czech Republic. Micro Matic is a prominent world producer of spears. All Micro Matic spears feature high quality, long service life and offer high level of safety and quality in handling kegs.

A-system **Flach**

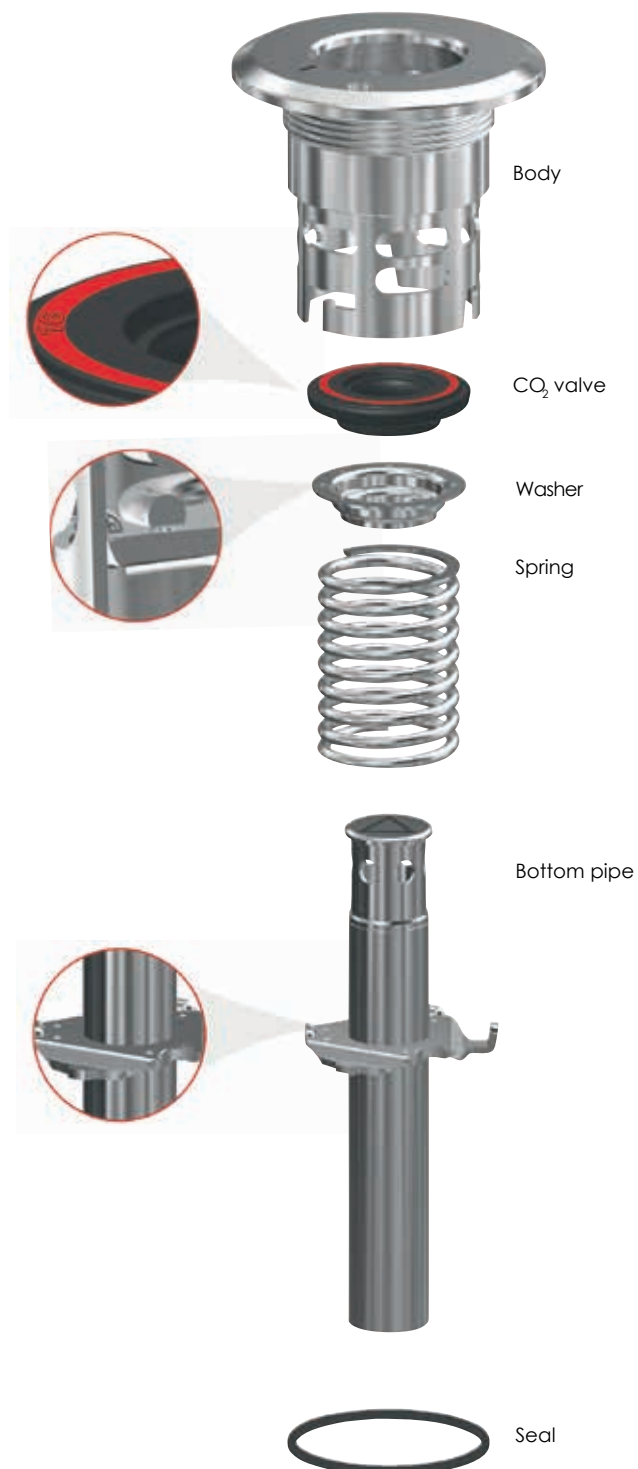

M - system **Kombi**



Body



CQ valve



Beer valve



Beer spring



Bottom pipe



CQ spring



Safety disc



Seal





S-system **Korb**



Body



CO₂ valve



Beer valve



Beer spring



Bottom pipe



CO₂ spring



Safety disc



O-Ring



Cooling and freezing equipment

Coolers
Wine coolers



**THERMOTECHNIKA
CROWN COOL**



SC 21 - Glass door cooler

- External dimensions: 360 x 330 x 585 mm
- Net weight: 18 kg
- Input power: 90 W
- Refrigeration range: (+25°C, 60% Rh) +0 ... +10 °C
- Shelf dimensions: 254 x 212 mm
- Energy consumption: 274 kWh/year
- Refrigerant: R600a
- Voltage: 220 V/ 50 Hz
- Net volume: 18 l
- Gross weight: 19 kg

Glass door cooler with ventilation cooling, 1 adjustable white wire shelf, advertising display, internal LED lighting and 4 feet. Climate class N.



TC 160GDAN - Glass door cooler

- External dimensions: 600 x 585 x 855 mm
- Net weight: 43 kg
- Input power: 122 W
- Refrigeration range: (+25°C, 60% Rh) +2 ... +12 °C
- Energy consumption: 394 kWh/year
- Refrigerant: R600a
- Internal dimensions: 516 x 457 x 706 mm
- Voltage: 230 V/ 50 Hz
- Net volume: 142 l
- Gross weight: 45 kg

The glass door cooler is equipped with dynamic cooling, 2 shelves, plastic covered metal steel outside, aluminium inside, digital temperature control, internal vertical LED light and and extra ventilation for condensation that makes the cooler especially suitable for use even when tightly built in under the counter.



KH-VC220 GD - Glass door cooler

- External dimensions: 595 x 640 x 1310 mm
- Net weight: 58 kg
- Gross volume: 215 l
- Refrigeration range: (+30°C, 55% Rh) +1 ... +10 °C
- Energy consumption: 694 kWh/year
- Refrigerant: environmentally friendly
- Internal dimensions: 505 x 462 x 1025 mm
- Supply: 2 A
- Net volume: 190 l
- Weight: 65 kg
- Noise: 46,8 dB
- Voltage: 230 V/ 50 Hz

The cooler is equipped with 3 shelves, painted exterior, ABS interior, dynamic cooling, internal LED light and lock.



KH-VC374 GDCA - Glass door cooler

- External dimensions: 595 x 640 x 1980 mm
- Noise: 46,8 dB
- Net weight: 78 kg
- Gross volume: 372 l
- Input power: 370 W
- Refrigeration range: (+30°C, 55% Rh) +1 ... +10 °C
- Energy consumption: 821 kWh/year
- Refrigerant: environmentally friendly
- Internal dimensions: 505 x 462 x 1555 mm
- Voltage: 230 V/ 50 Hz
- Net volume: 345 l
- Supply: 2,7 A
- Weight: 85 kg

Glass door cooler with dynamic cooling, 5 shelves, lock, LED light and mechanical thermostat.



KH-VC1000 GDSCCA - Sliding glass door cooler

- External dimensions: 1000 x 742 x 2000 mm
- Input power: 700 W
- Refrigeration range: (+30 °C, 55% Rh) +1 ... +10 °C
- Energy consumption: 2175 kWh/year
- Refrigerant: environmentally friendly
- Internal dimensions: 890 x 572 x 1533 mm
- Weight: 160 kg
- Net volume: 524 l
- Voltage: 230 V/ 50 Hz
- Noise: 55,4 dB

The cooler is equipped with 2x5 shelves, sliding glass door, advertising display, one cooling space, painted exterior, aluminium interior, mechanical thermostat, dynamic cooling and internal light.



KH-VC1200 GDSCCA - Sliding glass door cooler

- External dimensions: 1200 x 742 x 2000 mm
- Input power: 850 W
- Refrigeration range: (+30 °C, 55% Rh) +1 ... +10 °C
- Energy consumption: 2482 kWh/year
- Refrigerant: environmentally friendly
- Internal dimensions: 1090 x 572 x 1533 mm
- Weight: 178 kg
- Net volume: 645 l
- Voltage: 230 V/ 50 Hz
- Noise: 55,4 dB

The cooler is equipped with 2x5 shelves, sliding glass door, advertising display, one cooling space, painted exterior, aluminium interior, mechanical thermostat, dynamic cooling and internal light.



TC BB2GD - Double glass door bar cooler

- External dimensions: 1462 x 520 x 840 mm
- Input power: 250 W
- Refrigeration range: (+25°C, 60% Rh) +2 ... +10 °C
- Energy consumption: 2,4 kWh/24h
- Weight: 105 kg
- Net volume: 290 l
- Refrigerant: environmentally friendly

The high quality, own manufactured back bar cooler is equipped with 2 glass doors, 40 mm poliuretane insulation, electronic controller with auto defrost and digital temperature display, self closing hinged doors with standard locks, bright interior illumination with separate on/off switch, adjustable feet and 2 shelves per door.



TC 190 LILLA - Promotional cooler

- External dimensions: 1333 x 484 x 595 mm
- Input power: 75 W
- Refrigeration range: (+25°C, 60% Rh) +4 ... +12 °C
- Refrigerant: R600a
- Weight: 96 kg
- Net volume: 170 l

The horizontal display cooler is equipped with internal LED light, digital temperature control, dynamic cooling, 2 glass shelves, glass door, rounded edges, aluminium moldings. Glass shelves make the products stored in them look more beautiful and transparent.



TC 400SD - Solid door cooler

- External dimensions: 595 x 625 x 1846 mm
- Net weight: 88 kg
- Input power: 180 W
- Refrigeration range: (+25°C, 60% Rh) +2 ... +12 °C
- Maximum shelf capacity: 30 kg
- Energy consumption: 1,18 kWh/24h
- Refrigerant: R600a
- Voltage: 230 V/ 50 Hz
- Internal dimensions: 505 x 480 x 1555 mm
- Gross volume: 400 l
- Net volume: 375 l
- Weight: 103 kg

The refrigerator is equipped with 5 shelves, plastic coated sheet inside and outside, digital temperature control, digital temperature display, dynamic cooling and adjustable feet.



TC 400GD - Glass door cooler

- External dimensions: 595 x 625 x 1846 mm
- Gross volume: 400 l
- Input power: 180 W
- Refrigeration range: (+25°C, 60% Rh) +1 ... +12 °C
- Maximum shelf capacity: 30 kg
- Energy consumption: 1,18 kWh/24h
- Refrigerant: R600a
- Internal dimensions: 505 x 480 x 1555 mm
- Velikost police: 480x440 mm
- Voltage: 230 V/ 50 Hz
- Net volume: 375 l

The refrigerator is equipped with 5 shelves, plastic coated sheet inside and outside, digital temperature control, digital temperature display, internal led light, dynamic cooling and adjustable feet.



TC 600R - Cooler with separated containers

- External dimensions: 700 x 825 x 1865 mm
- Gross volume: 600 l
- Input power: 201 W
- Refrigeration range: (+25°C, 60% Rh) +2 ... +12 °C
- Energy consumption: 1,21 kWh/24h
- Refrigerant: R600a
- Internal dimensions: 600 x 715 x 1400 mm
- Voltage: 230 V/ 50 Hz
- Net volume: 547 l
- Supply: 1,32 A
- Container size: 300 x 610 x 250 mm

The refrigerator is equipped with 10 pcs lockable racks (capacity 15 kg/rack), plastic coated sheet inside and outside, digital temperature display, adjustable feet and dynamic cooling



TC 600GD - Glass door cooler

- External dimensions: 700 x 825 x 1865 mm
- Internal dimensions: 600 x 715 x 1400 mm
- Input power: 201 W
- Refrigeration range: (+25°C, 60% Rh) +1 ... +12 °C
- Maximum shelf capacity: 30 kg
- Energy consumption: 1,21 kWh/24h
- Refrigerant: R600a
- Voltage: 230 V/ 50 Hz
- Shelf dimensions: 575 x 640 mm
- Gross volume: 600 l
- Net volume: 573 l
- Weight: 127 kg

The refrigerator is equipped with 5 shelves, plastic coated exterior and interior, adjustable feet, digital temperature control, digital temperature display, internal light and dynamic cooling.

Based upon a few standard modules it offers a wide variety of possibilities. We offer a choice of 2, 3 or 4 module models in which modules are combined with full or glass doors, modules with drawers and bottle openings. Each model can be ordered with a standard cooling unit or with a split unit - without aggregate.

TC BBCL2-22 - Bar cooler with two solid doors

- External dimensions: 1245 x 560 x 850 mm
- Input power: 310 W
- Gross volume: 300 l
- Refrigeration range: +2 ... +10 °C
- Refrigerant: R290



TC BBCL3-332G - Bar cooler with drawers and glass door

- External dimensions: 1720 x 560 x 850 mm
- Input power: 390 W
- Gross volume: 470 l
- Refrigeration range: +2 ... +10 °C
- Refrigerant: R290



TC BBCL4-6622 - Bar cooler with drawers and two solid doors

- External dimensions: 2195 x 560 x 850 mm
- Input power: 390 W
- Gross volume: 635 l
- Refrigeration range: +2 ... +10 °C
- Refrigerant: R290



Bar coolers have ventilated cooling (quick cooling effect), 2 adjustable metal shelves for each door, electronic thermostat with automatic defrost, adjustable feet, inner LED light also in drawers, fully extendable drawers on telescopic rails, exchangeable door seals. Silver coloured skinplate inside, anthracite coloured skinplate outside. Easy connection of beer hoses with tap through to pre-drilled holes on sides of the device.

Simple service - completely removable cooling unit. The TC BBCL machine unit is environment friendly (Natural refrigerant R290) and energy efficient (Higher cooling power with 35% less energy consumption).



SW-38 - Double sectioned wine cooler

- External dimensions: 395 x 585 x 1020 mm
- Gross volume: 125 l
- Input power: 117 W
- Refrigeration range: (+25°C, 60% Rh) +5 ... +22 °C
- Energy consumption: 0,7 kWh/24h
- Refrigerant: environmentally friendly
- Voltage: 220-240 V/50 Hz
- Weight: 43,5 kg

The double sectioned compressor cooled wine cooler is equipped with black casing and sides, stainless steel doors with double layered, tinted glass, 7 wooden sliding shelves, 2 separate temperature controls, internal LED light, ventilation and lock. Storage capacity: 38-50 wine bottles.



SW-66 - Double sectioned wine cooler

- External dimensions: 595 x 580 x 1020 mm
- Gross volume: 190 l
- Input power: 120 W
- Refrigeration range: (+25°C, 60% Rh) +5 ... +22 °C
- Energy consumption: 0,81 kWh/24h
- Voltage: 220-240 V/50 Hz
- Weight: 56 kg

The double sectioned compressor cooled wine cooler is equipped with black casing and sides, stainless steel doors with double layered, tinted glass, 7 wooden sliding shelves, 2 separate temperature controls, internal LED light, ventilation and lock. Storage capacity: 66-80 wine bottles.

SW-180 - Double sectioned wine cooler

- External dimensions: 595 x 680 x 1840 mm
- Gross volume: 480 l
- Input power: 170 W
- Refrigeration range: (+25°C, 60% Rh) +5 ... +22 °C
- Energy consumption: 1,30 kWh/24h
- Voltage: 220-240 V/50 Hz
- Weight: 90 kg

The double sectioned compressor cooled wine cooler is equipped with black casing and sides, stainless steel doors with double layered, tinted glass, 8 wooden sliding shelves, 2 separate temperature controls, internal LED light, ventilation and lock. Storage capacity: 181-205 wine bottles.



TC 400WAN - Wine cooler

- External dimensions: 595 x 625 x 1846 mm
- Gross volume: 400 l
- Input power: 180 W
- Refrigeration range: +6 ... +13 °C
- Energy consumption: 1,18 kWh/24h
- Voltage: 230 V/50 Hz
- Weight: 94 kg
- Refrigerant: R600a

Wine cooler with anthracite plastic coated sheet exterior, grey plastic coated sheet interior, stainless steel handle, 7 pcs wooden shelves (6+1 tilted), 2-side vertical blue LED lighting. The door frame is made of stainless steel. Suitable for 42 bottles.



TC 500WAN - Wine cooler

- External dimensions: 700 x 705 x 1865 mm
- Gross volume: 500 l
- Input power: 201 W
- Refrigeration range: +6 ... +13 °C
- Energy consumption: 1,21 kWh/24h
- Voltage: 230 V/50 Hz
- Gross weight: 127 kg
- Refrigerant: environmentally friendly

Wine cooler with anthracite plastic coated sheet exterior, grey plastic coated sheet interior, stainless steel handle, 7 pcs wooden shelves (6+1 tilted), 2-side vertical blue LED lighting. Suitable for 49 bottles.

TC 160WAN - Wine cooler

- External dimensions: 585 x 600 x 855 mm
- Gross volume: 160 l
- Input power: 122 W
- Refrigeration range: +6 ... +13 °C
- Energy consumption: 1,08 kWh/24h
- Refrigerant: R600a
- Voltage: 230 V/50 Hz
- Weight: 45 kg
- Supply: 0,5 A

Wine cooler with anthracite plastic coated sheet exterior, grey plastic coated sheet interior, stainless steel handle, 3 pcs wooden shelves (2+1 tilted), 2-side vertical blue LED lighting. The door frame is made of stainless steel. Suitable for 18 bottles.





**THERMOTECHNIKA
CROWN COOL**



Stainless steel bar counters

Stainless steel bar counters for catering facilities

„Tailor-made“ according to the customer's wishes

The material used is austenitic stainless steel, which is suitable for contact with food. To the maximum extent possible the products use the quality of that hygienic material feature, extremely long service life and are easy to maintain.

We offer stainless steel tables for gastronomy in standard and custom versions, according to the customer's requirements.

We offer the same standards for all products:

- use of stainless steel for food purposes
- perfect production processing
- perfectly smoothed welds, fine grinding and polishing
- circumferential recesses for better hygiene, reinforcing recesses (circumferential, central) to increase strength
- high quality, comfort of operation and maintenance, functionality
- heated or cooled versions also available





**THERMOTECHNIKA
CROWN COOL**



Cooling and freezing chambers

Professional cooling and freezing chambers with solid and glass doors



Cooling chambers manufactured by THERMOTECHNIKA BOHEMIA s.r.o. are created in accordance with the requirements for storage of not only food but also other products (pharmaceutical, cosmetic, chemical products) and always adapt to the specific requirements of customers.

Chambers with glass doors:

- slim cooling chamber
- cooling chamber
- freezing chamber



Chambers with full doors:

- cooling chamber
- freezing chamber
- freezing (holding) chamber
- shocking chamber





THERMOTECHNIKA CROWN COOL





THERMOTECHNIKA CROWN COOL

Beer tanks - a better way to serve beer...

Our company offers beer tanks produced by company Fib Beer Systems. Fib Beer Systems is a Dutch company with more than 38 years of experience in production of beer tanks and has produced over 20,000 pieces of beer tanks during its existence that can be found in restaurants, bars or cafes around the world.



Our company THERMOTECHNIKA BOHEMIA offers a complex solution of tank technology, starting with design creation and ending with installation of the entire tank technology, including maintenance provided by our experienced technicians throughout the Czech Republic. We also hold a stock of liners (bags for tanks) for our customers.

Why tank beer?

- high quality beer
- longer beer life
- stable temperature and pressure
- no CO2 is needed
- no loss during tapping
- saves time
- saving people in logistics

In addition to beer tanks, we also offer:

Delivery tanks or beer lorries

Event beer tanks (festivals)

Containers or trailers equipped with several beer tanks

Mobile bar with beer tank

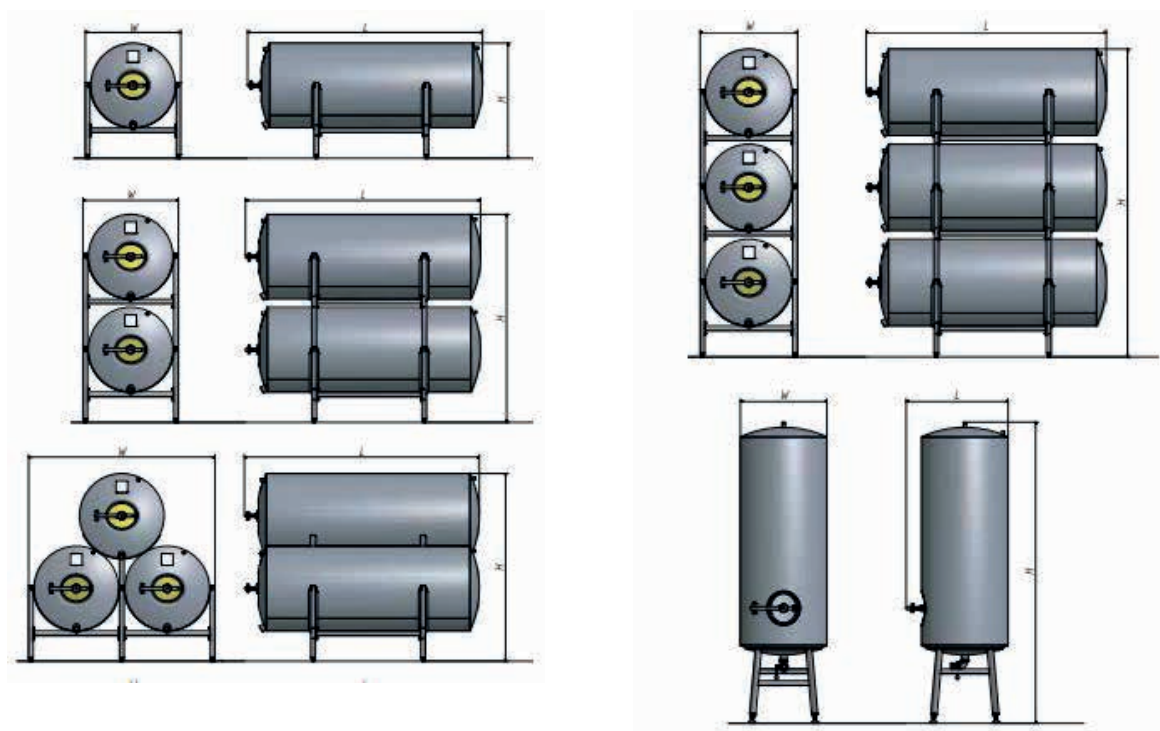

Volume [l]	Insulation		Type		Surface finish		Color/ Branded foil
	Uninsulated	Insulated	Horizontal	Vertical	stainless	copper	
125	Yes	Yes	Yes	No	Yes	Yes	Yes
250	Yes	Yes	Yes	Yes	Yes	Yes	Yes
500	Yes	Yes	Yes	Yes	Yes	Yes	Yes
1000	Yes	Yes	Yes	No	Yes	Yes	Yes



Logistics options



Logistics options



Event beer tanks



Mobile bar

Our suppliers



Our references





THERMOTECHNIKA CROWN COOL

SERVICE CENTRE
Dolní Beřkovice
address: Nádražní 111,
277 01 Dolní Beřkovice
tel. : +420 725 163 117



SERVICE CENTRE
Dolní Roveň
address: Dolní Roveň 153
533 71 Dolní Roveň
tel. : +420 734 696 765



SERVICE CENTRE
Paskov
address: Místecká 845,
739 21 Paskov
tel. : +420 725 805 030

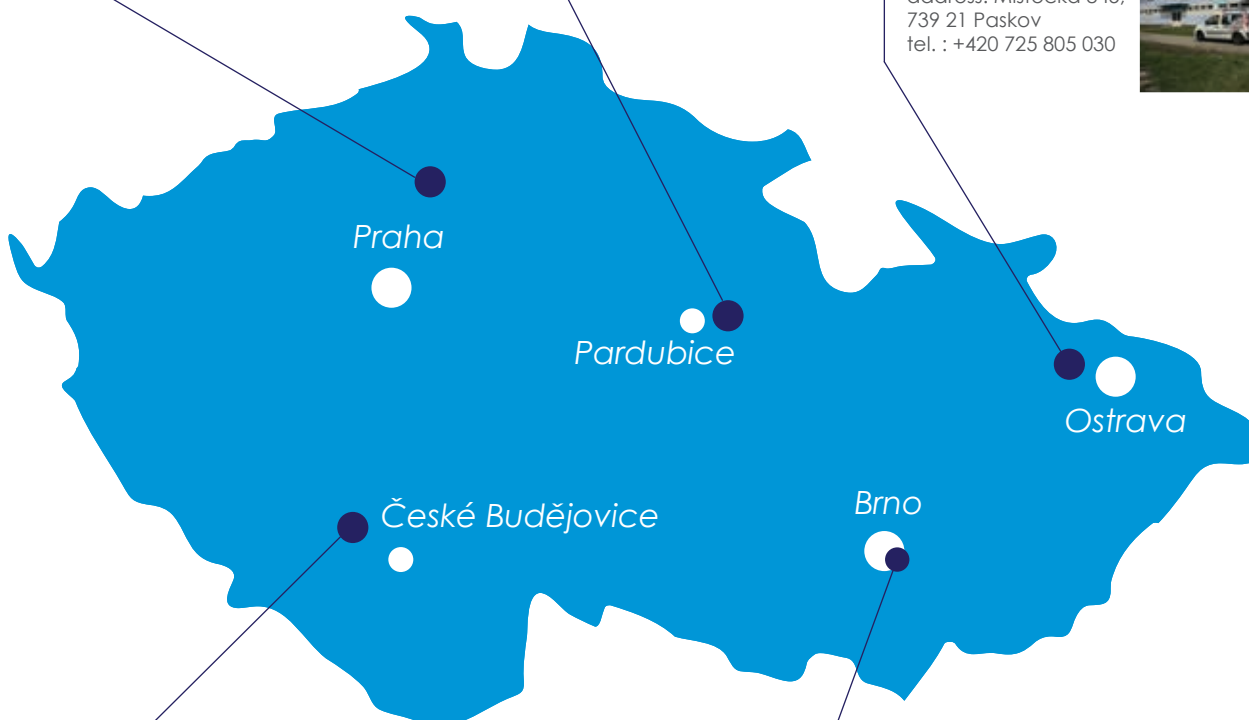

SERVICE CENTRE
Vodňany
address: Výstavní 1218,
389 01 Vodňany
tel. : +420 725 163 118



COMPANY HEADQUARTERS
Újezd u Brna
address: Komenského 951,
664 53 Újezd u Brna
tel. : +420 544 229 478



CENTRÁLNÍ SERVISNÍ STŘEDISKO
address: Hostěrádky-Rešov 15
683 52 Hostěrádky-Rešov
tel. : +420 603 196 020



THERMOTECHNIKA BOHEMIA s.r.o.

with the registered office at: Komenského 951, 664 53 Újezd u Brna

Company Registration Number: 46969829

recorded in the Companies Register

administered by the Regional Court in Brno, Section: C, File No.: 7152

e-mail: obchod@tcbohemia.com

Dispatching centre
+420 513 030 630

www.tcbohemia.com
www.thermotechnika.cz
www.vycepni-stojany.cz